



TRANSLAS [®]
DUTCH WELDING TECHNOLOGY

NORTH AMERICA



EXTRACTION

NO FUMES, ONLY CLEAN AIR



ABOUT **TRANSLAS**

Translas is a Dutch manufacturer of welding guns since 1960. A company founded by welders, for welders with a passion for innovation and new technologies. Translas continually strives to engineer innovative products that boast a distinctive design, quality, and functionality.

Welder's safety is of paramount importance to Translas. The company's goal is to globally reduce welders' exposure to hazardous fumes and provide a healthier and safer work environment. Some of the pioneering products include extractor guns with a built-in module to safely extract welding fumes at the source and portable extraction units for high-performance extraction.

www.translas.com

TABLE OF CONTENTS

SAFE & EFFECTIVE EXTRACTION OF WELDING FUMES AT THE SOURCE

ABOUT TRANSLAS **2**

ABOUT WELDING FUMES **4**

8XE MIG EXTRACTOR **5**

8XR COBOT MIG EXTRACTOR **28**

8TE TIG EXTRACTOR **42**

CLEARO2 **56**



Extraction Catalogue

Scan the QR code with your smart phone



About Welding Fumes:

Welding fumes contain vapours, a mixture of airborne gas by-products and fine particles. The composition of the mixture depends on the welding method and the products that are welded. The vapours and gases released during welding can lead to serious health problems. Short-term exposure can result in nausea, dizziness, or eye, nose, and throat irritation.

Prolonged exposure is like inhaling ultra-fine metal dust which can lead to cancer of the lung, damage to the brain, and kidney damage. Certain gases, such as helium, carbon dioxide, and argon, displace oxygen and argon specifically posing suffocation risks in enclosed work areas. For this reason, Translas, a Dutch welding gun manufacturer, developed fume welding guns – 8XE MIG, 8XR Cobot, and 8TE TIG Extractors – that extract the welding fumes directly at the source up to 98%.

CLEAN AIR

- ✓ **SOURCE EXTRACTION & FILTRATION**
- ✓ **ENGINEERED FOR THE WELDING PROCESS**
- ✓ **COMPLETE RANGE FOR YOUR PLANT/SHOP**
- ✓ **HIGH QUALITY, TESTED EQUIPMENT**
- ✓ **USER-FRIENDLY UNITS, READY TO USE**

TRANSLAS [®]
DUTCH WELDING TECHNOLOGY

8XE MIG EXTRACTOR

EXTRACTION

NO FUMES, ONLY CLEAN AIR





8XE MIG EXTRACTOR



MIG
EXTRACTOR

CLEAN AIR

8XE MIG EXTRACTOR

SAFE & EFFECTIVE EXTRACTION OF WELDING FUMES DIRECTLY AT THE SOURCE.

The 8XE MIG Extractor integrates the most efficient fume extraction structure in the welding industry. The gun comes with three different angles, 30°, 45°, and straight. The 8XE MIG Extractor, combined with the ClearO2 W-series 100 and 200, captures up to 98% of welding fumes directly at the source. The 8XE MIG Extractor provides the safest and most effective solution for welders and workers to breathe CLEAN AIR and enjoy better work environments.



CLEAN AIR

SOURCE EXTRACTION



THE ROBUST CONNECTION BETWEEN SWANNECK & METAL NECK.

The new nozzle holder provides a robust connection between Swanneck and Metal Neck. It is designed to take the biggest blows in any industrial environment.

UNIQUE NOZZLE DESIGN FOR OPTIMAL PERFORMANCE AND DURABILITY.

The nozzle design is unique to provide the best results. Openings, wall thickness and grip ribs are thoroughly developed for optimal operation and best performance.





8XE MIG EXTRACTOR

MIG
EXTRACTOR

PRODUCT FEATURES

- ✓ RESULTS MEASURED BY DUTCH RESEARCH INSTITUTE (TNO) IN "WORST CASE SCENARIO"
- ✓ UNIQUE CONTACT TIP FOR MAXIMUM DURABILITY
- ✓ VARIOUS GAS NOZZLES FOR BEST PERFORMANCE
- ✓ DESIGNED FOR ENLARGED ANGULAR MOVEMENT
- ✓ MADE FROM VERY STRONG DSM PLASTIC
- ✓ THE SWAN NECK IS SECURED IN TWO PLACES



- ✓ PATENTED
- ✓ LIGHT-WEIGHT
- ✓ ROBUST

EXTRACTION

Reduces
Welding Fumes
up to **98%**

Lowest
Under-Pressure
in the Market

ERGONOMIC BALL SOCKET: 30° ANGLE AND 360° ROTATABLE



8XE ball joint has a 30° vertical angular movement combined with a 360° swivel and a full stop. Providing excellent maneuverability and leaving cables and hoses untwisted and thereby leakage and breakage free. This combination is new to the market. It offers excellent maneuverability, maximizing comfort and minimizing fatigue.







8XE MIG EXTRACTOR LINE



200 AIR COOLED
MINI

CO2 - 230 AMP
Mixed Gases - 200 AMP
Duty Cycle - 100%
Weight*: 2.4 lb



250 AIR COOLED
MINI

CO2 - 280 AMP
Mixed Gases - 250 AMP
Duty Cycle - 100%
Weight*: 2.9 lb



400 AIR COOLED

CO2 - 420 AMP
Mixed Gases - 400 AMP
Duty Cycle - 100%
Weight*: 3.28 lb



500 WATER COOLED

CO2 - 550 AMP
Mixed Gases - 500 AMP
Duty Cycle - 100%
Weight*: 3.7 lb

EXTRACTION

* The gun's weight is measured 3' above the ground.

8XE MINI 200 MIG EXTRACTOR

CO2 - 230 AMP, MIXED GASES - 200 AMP, DUTY CYCLE - 100%



AIR COOLED

CLEAN AIR

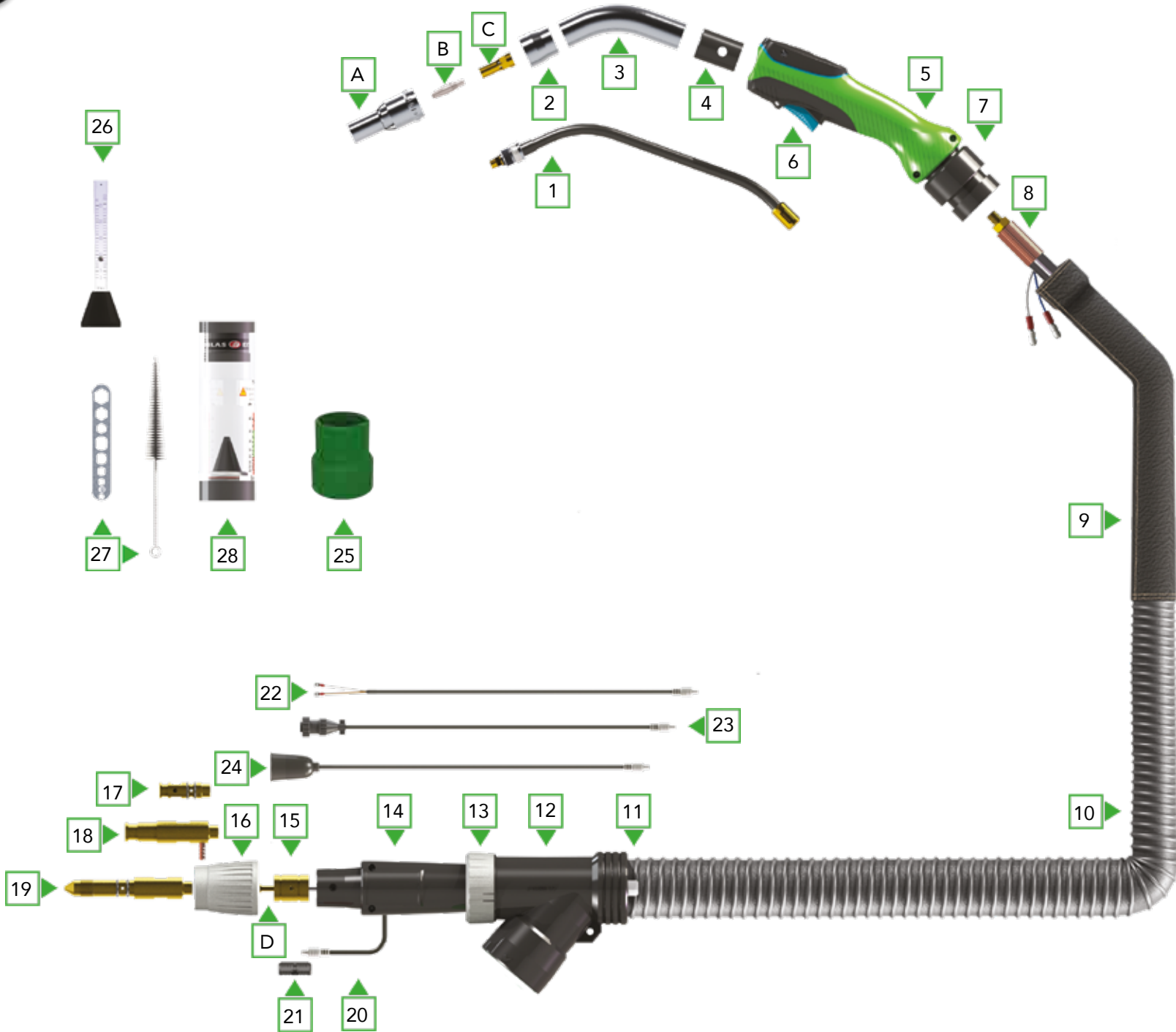

PART NO.	DESCRIPTION	PACK QTY
COMPLETE TORCHES		
8XO1001305000	8XE MINI Extractor USA 200AMP 10ft (3mtr) air cooled - 45° (standard)	1
8XO1001405000	8XE MINI Extractor USA 200AMP 13ft (4mtr) air cooled - 45° (standard)	1
8XO1001505000	8XE MINI Extractor USA 200AMP 16ft (5mtr) air cooled - 45° (standard)	1
8XO1001605000	8XE MINI Extractor USA 200AMP 20ft (6mtr) air cooled - 45° (standard)	1
8XO1501305000	8XE MINI Extractor USA 200AMP 10ft (3mtr) air cooled - straight	1
8XO1501405000	8XE MINI Extractor USA 200AMP 13ft (4mtr) air cooled - straight	1
8XO1501505000	8XE MINI Extractor USA 200AMP 16ft (5mtr) air cooled - straight	1
8XO1501605000	8XE MINI Extractor USA 200AMP 20ft (6mtr) air cooled - straight	1

ITEM	PART NO.	DESCRIPTION	PACK QTY
CONSUMABLES			
A	3937000	Nozzle conical 12mm	5
	3937001	Nozzle conical 14mm special	5
	3937002	Nozzle conical 14mm	5
B	399008	Contact Tip 8XR/8XE - .030 (0.8)	25
	399010	Contact Tip 8XR/8XE - .040 (1.0)	25
	399012	Contact Tip 8XR/8XE - .045 (1.2)	25
	3990102	Contact Tip 8XR/8XE - .040 (1.0) Alu	25
	3990122	Contact Tip 8XR/8XE - .045 (1.2) Alu	25
	3990091	Contact Tip 8XR/8XE - .035 (0.9) CuCrZr	25
	3990101	Contact Tip 8XR/8XE - .040 (1.0) CuCrZr	25
	3990121	Contact Tip 8XR/8XE - .045 (1.2) CuCrZr	25
C	39327110	Tip adapter	10
D	301535-USA	Plastic coated liner blue 10ft (3mtr) - for .030 wire	1
	301545-USA	Plastic coated liner blue 13ft (4mtr) - for .030 wire	1
	301555-USA	Plastic coated liner blue 16ft (5mtr) - for .030 wire	1
	301565-USA	Plastic coated liner blue 20ft (6mtr) - for .030 wire	1
	302535-USA	Plastic coated liner red 10ft (3mtr) - for .035 to .045 wire	1
	302545-USA	Plastic coated liner red 13ft (4mtr) - for .035 to .045 wire	1
	302555-USA	Plastic coated liner red 16ft (5mtr) - for .035 to .045 wire	1
	302565-USA	Plastic coated liner red 20ft (6mtr) - for .035 to .045 wire	1



ITEM	PART NO.	DESCRIPTION	PACK QTY
SPARE PARTS			
1	39301045	Swanneck 45°	1
	39301000	Swan neck straight	1
	3950005	PEEK ring to fix nozzle holder (not shown)	5
2	3950000	Nozzle holder	1
3	3950045	Metal neck 45°	1
	3950050	Metal neck straight	1
4	3950500	Adapter to fit MINI neck	1
5	391000	Handle green/black complete with trigger	1
6	3912009	Trigger with spring	1
	391250	Micro switch complete (not shown)	1
7	381900	Cable support set with ball-and-socket joint	1
8	259163X8	Cable assembly 10ft (3mtr)	1
	259164X8	Cable assembly 13ft (4mtr)	1
	259165X8	Cable assembly 16ft (5mtr)	1
	259166X8	Cable assembly 20ft (6mtr)	1
9	260019	Leather-sheathing with velcro 6ft (2mtr)	1
10	340303	Fume extraction hose 10ft (3mtr)	1
	340304	Fume extraction hose 13ft (4mtr)	1
	340305	Fume extraction hose 16ft (5mtr)	1
	340306	Fume extraction hose 20ft (6mtr)	1
11	398031	Hose connection	1
12	398100	Housing (Y-shape) for fume extraction hose	1
13	398015	Connection ring	1
14	398010	Housing set for central connector	1
15	3059001	Central connector	1
16	398200	Adaptor nut	1
17	3059100	Tweco tail	1
18	3059200S	Lincoln tail complete with gas hose	1
19	3059150	Miller tail	1
20	349200	Switch cable 45cm (Quick connect)	1
21	306545	Locking clip (Quick connect)	5
22	349130	Tweco swith cable end (Quick connect)	1
23	349120	Miller swith cable end (Quick connect)	1
24	349110	Lincoln swith cable end (Quick connect)	1
25	398110	Hose adapter	1
26	406050	Gasflow meter	1
27	371208	Tool set (brush and multitool)	1
28	371350	Airflow meter MINI Extractor	1
-	320300	Ceramic dry film spray 400 ml (not shown)	12

EXTRACTION

8XE MINI 250 MIG EXTRACTOR

CO2 - 280 AMP, MIXED GASES - 250 AMP, DUTY CYCLE - 100%



AIR COOLED

CLEAN AIR

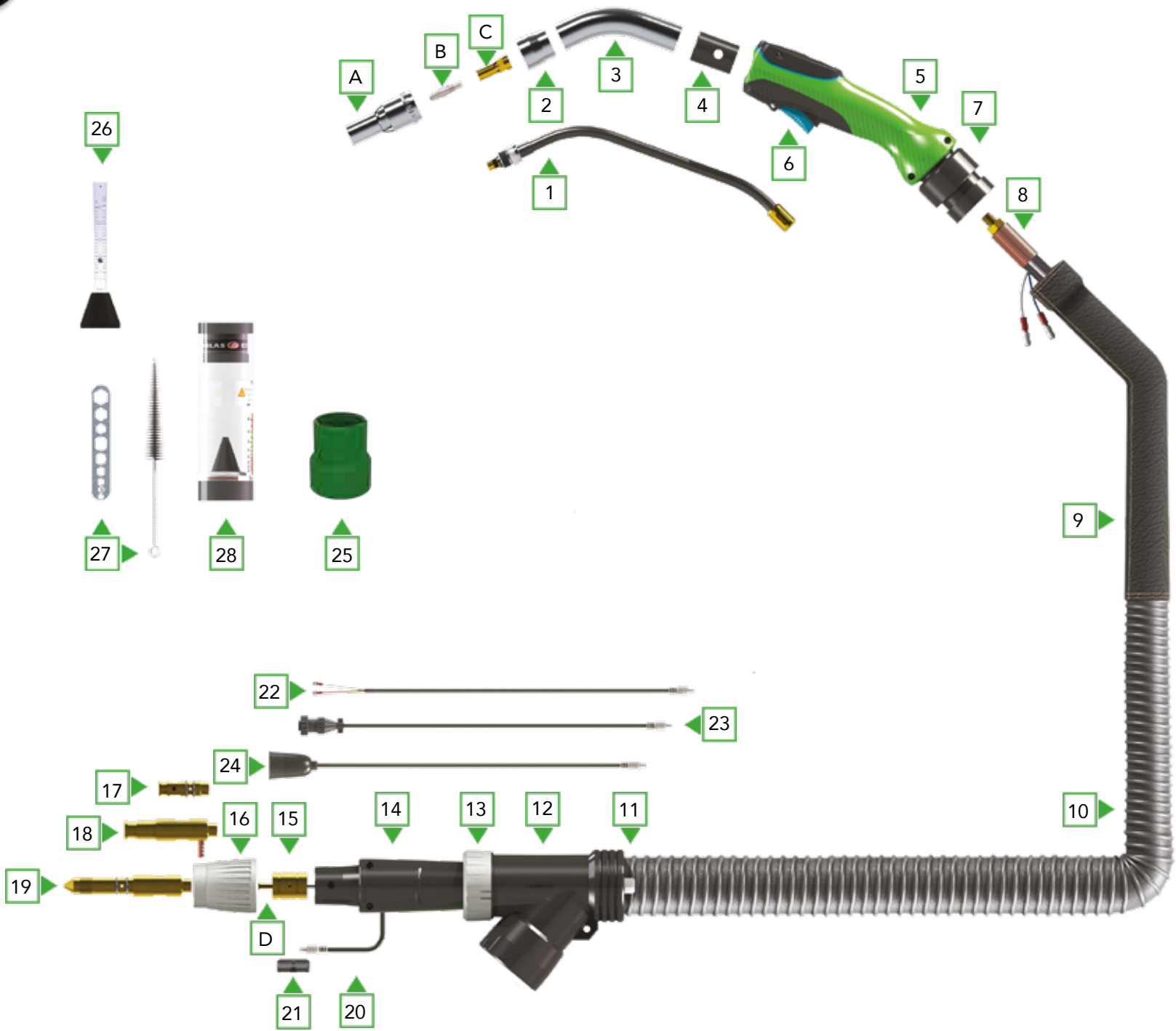

PART NO.	DESCRIPTION	PACK QTY
COMPLETE TORCHES		
8XO1000305000	8XE MINI Extractor USA 250AMP 10ft (3mtr) air cooled - 45° (standard)	1
8XO1000405000	8XE MINI Extractor USA 250AMP 13ft (4mtr) air cooled - 45° (standard)	1
8XO1000505000	8XE MINI Extractor USA 250AMP 16ft (5mtr) air cooled - 45° (standard)	1
8XO1000605000	8XE MINI Extractor USA 250AMP 20ft (6mtr) air cooled - 45° (standard)	1
8XO1500305000	8XE MINI Extractor USA 250AMP 10ft (3mtr) air cooled - straight	1
8XO1500405000	8XE MINI Extractor USA 250AMP 13ft (4mtr) air cooled - straight	1
8XO1500505000	8XE MINI Extractor USA 250AMP 16ft (5mtr) air cooled - straight	1
8XO1500605000	8XE MINI Extractor USA 250AMP 20ft (6mtr) air cooled - straight	1

ITEM	PART NO.	DESCRIPTION	PACK QTY
CONSUMABLES			
A	3937000	Nozzle conical 12mm	5
	3937001	Nozzle conical 14mm special	5
	3937002	Nozzle conical 14mm	5
B	399008	Contact Tip 8XR/8XE - .030 (0.8)	25
	399010	Contact Tip 8XR/8XE - .040 (1.0)	25
	399012	Contact Tip 8XR/8XE - .045 (1.2)	25
	3990102	Contact Tip 8XR/8XE - .040 (1.0) Alu	25
	3990122	Contact Tip 8XR/8XE - .045 (1.2) Alu	25
	3990091	Contact Tip 8XR/8XE - .035 (0.9) CuCrZr	25
	3990101	Contact Tip 8XR/8XE - .040 (1.0) CuCrZr	25
	3990121	Contact Tip 8XR/8XE - .045 (1.2) CuCrZr	25
C	39327110	Tip adapter	10
D	301535-USA	Plastic coated liner blue 10ft (3mtr) - for .030 wire	1
	301545-USA	Plastic coated liner blue 13ft (4mtr) - for .030 wire	1
	301555-USA	Plastic coated liner blue 16ft (5mtr) - for .030 wire	1
	301565-USA	Plastic coated liner blue 20ft (6mtr) - for .030 wire	1
	302535-USA	Plastic coated liner red 10ft (3mtr) - for .035 to .045 wire	1
	302545-USA	Plastic coated liner red 13ft (4mtr) - for .035 to .045 wire	1
	302555-USA	Plastic coated liner red 16ft (5mtr) - for .035 to .045 wire	1
	302565-USA	Plastic coated liner red 20ft (6mtr) - for .035 to .045 wire	1



ITEM	PART NO.	DESCRIPTION	PACK QTY
SPARE PARTS			
1	39301045	Swanneck 45°	1
	39301000	Swan neck straight	1
	3950005	PEEK ring to fix nozzle holder (not shown)	5
2	3950000	Nozzle holder	1
3	3950045	Metal neck 45°	1
	3950050	Metal neck straight	1
4	3950500	Adapter to fit MINI neck	1
5	391000	Handle green/black complete with trigger	1
6	3912009	Trigger with spring	1
	391250	Micro switch complete (not shown)	1
7	381900	Cable support set with ball-and-socket joint	1
8	259263X8	Cable assembly 10ft (3mtr)	1
	259264X8	Cable assembly 13ft (4mtr)	1
	259265X8	Cable assembly 16ft (5mtr)	1
	259266X8	Cable assembly 20ft (6mtr)	1
9	260019	Leather-sheathing with velcro 6ft (2mtr)	1
10	340303	Fume extraction hose 10ft (3mtr)	1
	340304	Fume extraction hose 13ft (4mtr)	1
	340305	Fume extraction hose 16ft (5mtr)	1
	340306	Fume extraction hose 20ft (6mtr)	1
11	398031	Hose connection	1
12	398100	Housing (Y-shape) for fume extraction hose	1
13	398015	Connection ring	1
14	398010	Housing set for central connector	1
15	3059001	Central connector	1
16	398200	Adaptor nut	1
17	3059100	Tweco tail	1
18	3059200S	Lincoln tail complete with gas hose	1
19	3059150	Miller tail	1
20	349200	Switch cable 45cm (Quick connect)	1
21	306545	Locking clip (Quick connect)	5
22	349130	Tweco swith cable end (Quick connect)	1
23	349120	Miller swith cable end (Quick connect)	1
24	349110	Lincoln swith cable end (Quick connect)	1
25	398110	Hose adapter	1
26	406050	Gasflow meter	1
27	371208	Tool set (brush and multitool)	1
28	371350	Airflow meter MINI Extractor	1
-	320300	Ceramic dry film spray 400 ml (not shown)	12

EXTRACTION

8XE MIG 400 EXTRACTOR

CO2 - 420 AMP, MIXED GASES - 400 AMP, DUTY CYCLE - 100%



AIR COOLED

CLEAN AIR

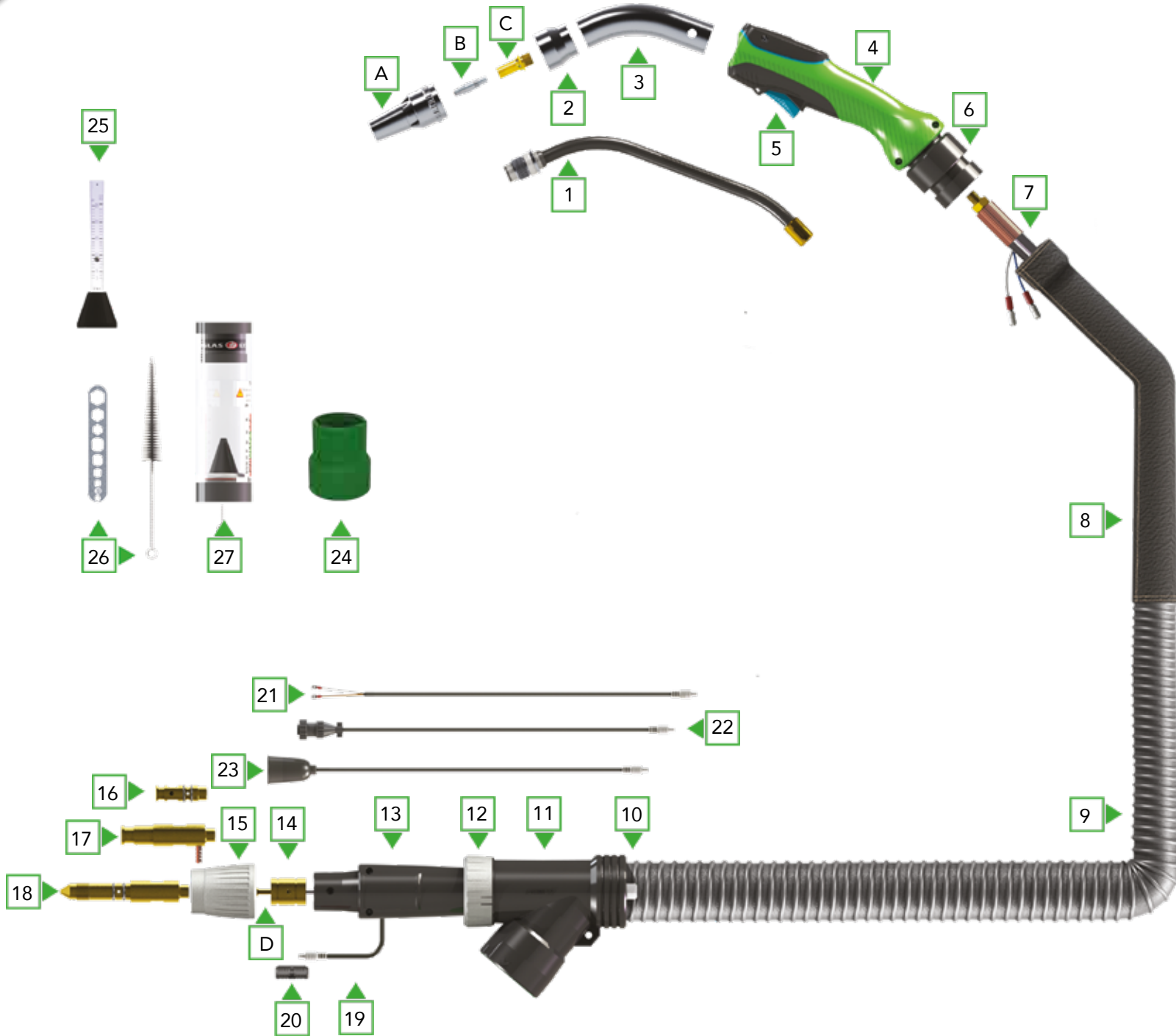

PART NO.	DESCRIPTION	PACK QTY
COMPLETE TORCHES		
8XO4028405000	8XE Extractor USA 400AMP 10ft (3mtr) air cooled - 45° (standard)	1
8XO4028405000	8XE Extractor USA 400AMP 13ft (4mtr) air cooled - 45° (standard)	1
8XO4028505000	8XE Extractor USA 400AMP 16ft (5mtr) air cooled - 45° (standard)	1
8XO4028605000	8XE Extractor USA 400AMP 20ft (6mtr) air cooled - 45° (standard)	1
8XO4528305000	8XE Extractor USA 400AMP 10ft (3mtr) air cooled - straight	1
8XO4528405000	8XE Extractor USA 400AMP 13ft (4mtr) air cooled - straight	1
8XO4528505000	8XE Extractor USA 400AMP 16ft (5mtr) air cooled - straight	1
8XO4528605000	8XE Extractor USA 400AMP 20ft (6mtr) air cooled - straight	1

ITEM	PART NO.	DESCRIPTION	PACK QTY
CONSUMABLES			
A	3937041	Nozzle conical .55 (14mm Special)	5
	3937045	Nozzle conical .67 (17mm Special)	5
B	399010	Contact Tip 8XR/8XE - 0.40 (1.0)	25
	399012	Contact Tip 8XR/8XE - 0.45 (1.2)	25
	399016	Contact Tip 8XR/8XE - 0.62 (1.6)	25
	3990102	Contact Tip 8XR/8XE - 0.40 (1.0) Alu	25
	3990122	Contact Tip 8XR/8XE - 0.45 (1.2) Alu	25
	3990091	Contact Tip 8XR/8XE - 0.35 (0.9) CuCrZr	25
	3990101	Contact Tip 8XR/8XE - 0.40 (1.0) CuCrZr	25
	3990121	Contact Tip 8XR/8XE - 0.45 (1.2) CuCrZr	25
	3990161	Contact Tip 8XR/8XE - 0.62 (1.6) CuCrZr	25
	3990201	Contact Tip 8XR/8XE - 0.78 (2.0) CuCrZr	25
	3990241	Contact Tip 8XR/8XE - 0.95 (2.4) CuCrZr	25
C	39327310	Tip adapter	10
D	303793-USA	Plastic coated liner black 10ft (3mtr) - for .040 to .045 wire	1
	303794-USA	Plastic coated liner black 13ft (4mtr) - for .040 to .045 wire	1
	303795-USA	Plastic coated liner black 16ft (5mtr) - for .040 to .045 wire	1
	303796-USA	Plastic coated liner black 20ft (6mtr) - for .040 to .045 wire	1
	303763-USA	Plastic coated liner grey 10ft (3mtr) - for .062 wire	1
	303764-USA	Plastic coated liner grey 13ft (4mtr) - for .062 wire	1
	303765-USA	Plastic coated liner grey 16ft (5mtr) - for .062 wire	1
	303766-USA	Plastic coated liner grey 20ft (6mtr) - for .062 wire	1
	303803-USA	Plastic coated liner green 10ft (3mtr) - for .078 to .095 wire	1
	303804-USA	Plastic coated liner green 13ft (4mtr) - for .078 to .095 wire	1
	303805-USA	Plastic coated liner green 16ft (5mtr) - for .078 to .095 wire	1
	303806-USA	Plastic coated liner green 20ft (6mtr) - for .078 to .095 wire	1



ITEM	PART NO.	DESCRIPTION	PACK QTY
SPARE PARTS			
1	39302145	Swanneck 45°	1
	39302100	Swan neck straight	1
	3950205	PEEK ring to fix nozzle holder (not shown)	5
2	3950200	Nozzle holder	1
3	3950245	Metal neck 45°	1
	3950250	Metal neck straight	1
4	391000	Handle green/black complete with trigger	1
5	3912009	Trigger with spring	1
	391250	Micro switch complete (not shown)	1
6	381920	Cable support set with ball-and-socket joint	1
7	259463X8U	Cable assembly 10ft (3mtr)	1
	259464X8U	Cable assembly 13ft (4mtr)	1
	259465X8U	Cable assembly 16ft (5mtr)	1
	259466X8U	Cable assembly 20ft (6mtr)	1
8	260018	Leather-sheathing with velcro 6ft (2mtr)	1
9	3402032	Fume extraction hose 10ft (3mtr)	1
	3402042	Fume extraction hose 13ft (4mtr)	1
	3402052	Fume extraction hose 16ft (5mtr)	1
	3402062	Fume extraction hose 20ft (6mtr)	1
10	398030	Hose connection	1
11	398100	Housing (Y-shape) for fume extraction hose	1
12	398015	Connection ring	1
13	398010	Housing set for central connector	1
14	30590012	Central connector	1
15	398200	Adaptor nut	1
16	3059100	Tweco tail	1
17	3059200S	Lincoln tail complete with gas hose	1
18	3059150	Miller tail	1
19	349200	Switch cable 45cm (Quick connect)	1
20	306545	Locking clip (Quick connect)	5
21	349130	Tweco swith cable end (Quick connect)	1
22	349120	Miller swith cable end (Quick connect)	1
23	349110	Lincoln swith cable end (Quick connect)	1
24	398110	Hose adapter	1
25	406050	Gasflow meter	1
26	371208	Tool set (brush and multitool)	1
27	371300	Airflow meter Extractor	1
-	320300	Ceramic dry film spray 400 ml (not shown)	12

8XE MIG 500 EXTRACTOR

CO2 - 550 AMP, MIXED GASES - 500 AMP, DUTY CYCLE - 100%



WATER COOLED

CLEAN AIR

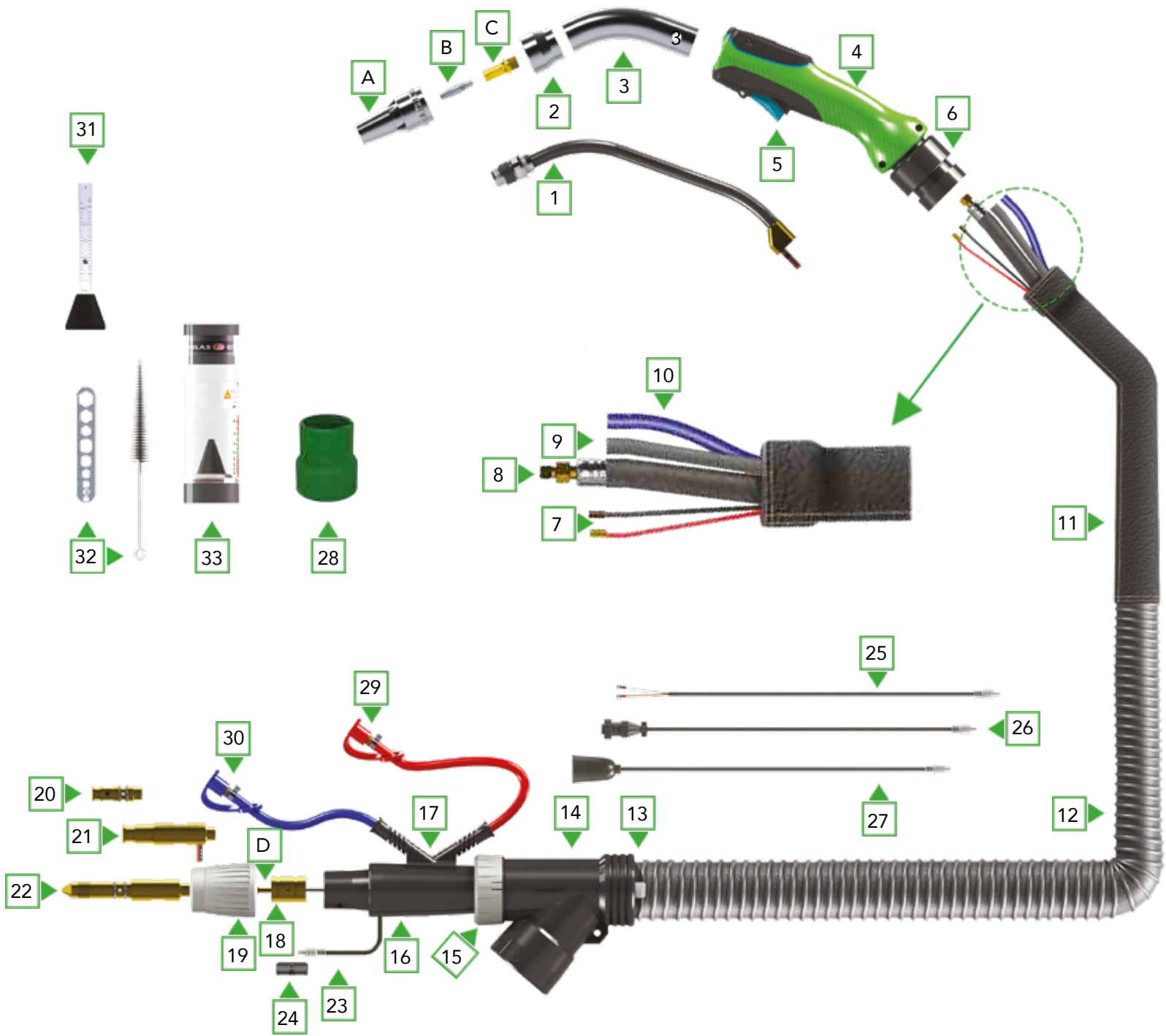

PART NO.	DESCRIPTION	PACK QTY
COMPLETE TORCHES		
8XO5060305000	8XE Extractor USA 500AMP 10ft (3mtr) water cooled - 45° (standard)	1
8XO5060405000	8XE Extractor USA 500AMP 13ft (4mtr) water cooled - 45° (standard)	1
8XO5060505000	8XE Extractor USA 500AMP 16ft (5mtr) water cooled - 45° (standard)	1
8XO5060605000	8XE Extractor USA 500AMP 20ft (6mtr) water cooled - 45° (standard)	1
8XO5560305000	8XE Extractor USA 500AMP 10ft (3mtr) water cooled - straight	1
8XO5560405000	8XE Extractor USA 500AMP 13ft (4mtr) water cooled - straight	1
8XO5560505000	8XE Extractor USA 500AMP 16ft (5mtr) water cooled - straight	1
8XO5560605000	8XE Extractor USA 500AMP 20ft (6mtr) water cooled - straight	1

ITEM	PART NO.	DESCRIPTION	PACK QTY
CONSUMABLES			
A	3937041	Nozzle conical .55 (14mm Special)	5
	3937045	Nozzle conical .67 (17mm Special)	5
B	399010	Contact Tip 8XR/8XE - 0.40 (1.0)	25
	399012	Contact Tip 8XR/8XE - 0.45 (1.2)	25
	399016	Contact Tip 8XR/8XE - 0.62 (1.6)	25
	3990102	Contact Tip 8XR/8XE - 0.40(1.0) Alu	25
	3990122	Contact Tip 8XR/8XE - 0.45 (1.2) Alu	25
	3990091	Contact Tip 8XR/8XE - 0.35 (0.9) CuCrZr	25
	3990101	Contact Tip 8XR/8XE - 0.40 (1.0) CuCrZr	25
	3990121	Contact Tip 8XR/8XE - 0.45 (1.2) CuCrZr	25
	3990161	Contact Tip 8XR/8XE - 0.62 (1.6) CuCrZr	25
C	39327210	Tip adapter	10
D	302535-USA	Plastic coated liner red 10ft (3mtr) - for .035 to .045 wire	1
	302545-USA	Plastic coated liner red 13ft (4mtr) - for .035 to .045 wire	1
	302555-USA	Plastic coated liner red 16ft (5mtr) - for .035 to .045 wire	1
	302565-USA	Plastic coated liner red 20ft (6mtr) - for .035 to .045 wire	1
	303635-USA	Plastic coated liner yellow 10ft (3mtr) - for .062 wire	1
	303645-USA	Plastic coated liner yellow 13ft (4mtr) - for .062 wire	1
	303655-USA	Plastic coated liner yellow 16ft (5mtr) - for .062 wire	1
	303665-USA	Plastic coated liner yellow 20ft (6mtr) - for .062 wire	1

ITEM	PART NO.	DESCRIPTION	PACK QTY
SPARE PARTS			
1	39303045	Swanneck 45°	1
	39303000	Swan neck straight	1
	3950205	PEEK ring to fix nozzle holder (not shown)	5
2	3950200	Nozzle holder	1
3	3950245	Metal neck 45°	1
	3950250	Metal neck straight	1

ITEM	PART NO.	DESCRIPTION	PACK QTY
SPARE PARTS			
4	391000	Handle green/black complete with trigger	1
5	3912009	Trigger with spring	1
	391250	Micro switch complete (not shown)	1
6	381920	Cable support set with ball-and-socket joint	1
7	306505	Switch cable 1x0,75mm ² per mtr	100
8	258513X8	Power/water cable 10ft (3mtr)	1
	258514X8	Power/water cable 13ft (4mtr)	1
	258515X8	Power/water cable 16ft (5mtr)	1
	258516X8	Power/water cable 20ft (6mtr)	1
9	2585313XE	Outer liner 10ft (3mtr)	1
	2585314XE	Outer liner 13ft (4mtr)	1
	2585315XE	Outer liner 16ft (5mtr)	1
	2585316XE	Outer liner 20ft (6mtr)	1
10	258535	Water inlet hose blue per mtr	100
	258566	Water outlet hose red per mtr	100
11	260018	Leather-sheathing with velcro 6ft (2mtr)	1
12	3402032	Fume extraction hose 10ft (3mtr)	1
	3402042	Fume extraction hose 13ft (4mtr)	1
	3402052	Fume extraction hose 16ft (5mtr)	1
	3402062	Fume extraction hose 20ft (6mtr)	1
13	398030	Hose connection	1
14	398100	Housing (Y-shape) for fume extraction hose	1
15	398015	Connection ring	1
16	398010	Housing set for central connector	1
17	350881	Water hose guide	1
18	3059002	Central connector	1
19	398200	Adaptor nut	1
20	3059100	Tweco tail	1
21	3059200S	Lincoln tail complete with gas hose	1
22	3059150	Miller tail	1
23	349200	Switch cable 45cm (Quick connect)	1
24	306545	Locking clip (Quick connect)	5
25	349130	Tweco swith cable end (Quick connect)	1
26	349120	Miller swith cable end (Quick connect)	1
27	349110	Lincoln swith cable end (Quick connect)	1
28	398110	Hose adapter	1
29	258701	Waterstop red	10
30	258702	Waterstop blue	10
31	406050	Gasflow metre	1
32	371208	Tool set (brush and multitool)	1
33	371300	Airflow meter Extractor	1
	320300	Ceramic dry film spray 400 ml (not shown)	12

EXTRACTION

8XE MINI 200 MIG EXTRACTOR (EURO)

CO2 - 230 AMP, MIXED GASES - 200 AMP, DUTY CYCLE - 100%



AIR COOLED

CLEAN AIR

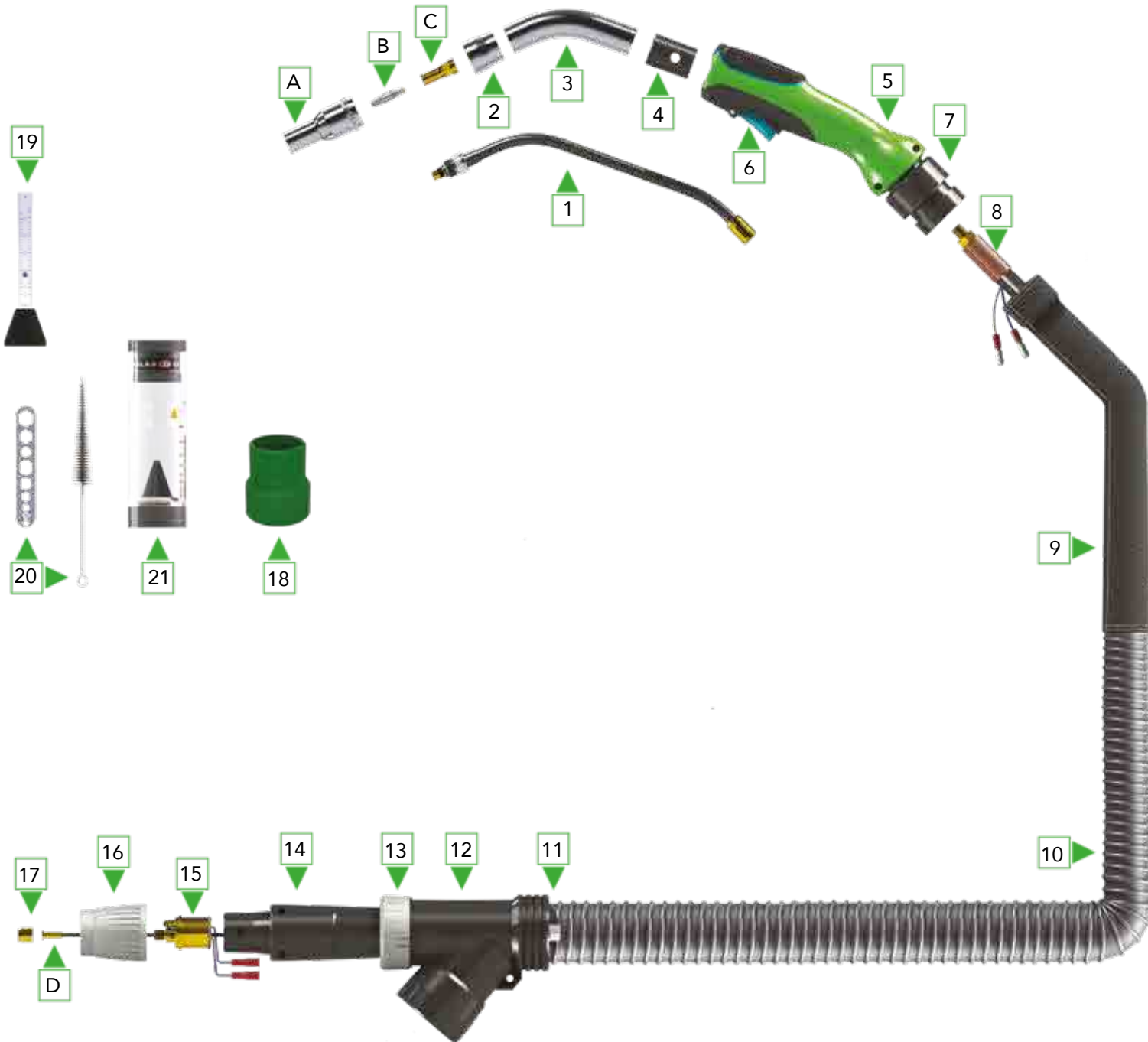

PART NO.	DESCRIPTION	PACK QTY
COMPLETE TORCHES		
8XE1001301000	8XE MINI Extractor 200AMP 10ft (3mtr) air cooled - 45° (standard)	1
8XE1001401000	8XE MINI Extractor 200AMP 13ft (4mtr) air cooled - 45° (standard)	1
8XE1001501000	8XE MINI Extractor 200AMP 16ft (5mtr) air cooled - 45° (standard)	1
8XE1101301000	8XE MINI Extractor 200AMP 10ft (3mtr) air cooled - 30°	1
8XE1101401000	8XE MINI Extractor 200AMP 13ft (4mtr) air cooled - 30°	1
8XE1101501000	8XE MINI Extractor 200AMP 16ft (5mtr) air cooled - 30°	1

ITEM	PART NO.	DESCRIPTION	PACK QTY
CONSUMABLES			
A	3937000	Nozzle conical 12mm	5
	3937001	Nozzle conical 14mm special	5
	3937002	Nozzle conical 14mm	5
B	399008	Contact Tip 8XR/8XE - .030 (0.8)	25
	399010	Contact Tip 8XR/8XE - .040 (1.0)	25
	399012	Contact Tip 8XR/8XE - .045 (1.2)	25
	3990102	Contact Tip 8XR/8XE - .040 (1.0) Alu	25
	3990122	Contact Tip 8XR/8XE - .045 (1.2) Alu	25
	3990101	Contact Tip 8XR/8XE - .040 (1.0) CuCrZr	25
	3990121	Contact Tip 8XR/8XE - .045 (1.2) CuCrZr	25
C	39327110	Tip adapter	10
D	301535	Plastic coated liner blue 10ft (3mtr) - for .030 wire	1
	301545	Plastic coated liner blue 13ft (4mtr) - for .030 wire	1
	301555	Plastic coated liner blue 16ft (5mtr) - for .030 wire	1
	302535	Plastic coated liner red 10ft (3mtr) - for .030 wire	1
	302545	Plastic coated liner red 13ft (4mtr) - for .030 wire	1
	302555	Plastic coated liner red 16ft (5mtr) - for .030 wire	1
	301538	Teflon liner blue 10ft (3mtr) - for .030 wire	1
	301548	Teflon liner blue 13ft (4mtr) - for .030 wire	1
	301558	Teflon liner blue 16ft (5mtr) - for .030 wire	1
	302538	Teflon liner red 10ft (3mtr) - for .030 wire	1
	302548	Teflon liner red 13ft (4mtr) - for .030 wire	1
	302558	Teflon liner red 16ft (5mtr) - for .030 wire	1

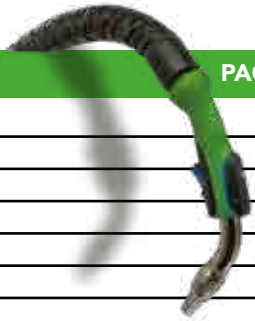

ITEM	PART NO.	DESCRIPTION	PACK QTY
SPARE PARTS			
1	39301045	Swanneck 45°	1
	39301030	Swanneck 30°	1
	3950005	PEEK ring to fix nozzle holder (not shown)	5
2	3950000	Nozzle holder	1
3	3950045	Metal neck 45°	1
	3950046	Metal neck 30°	1
4	3950500	Adapter to fit MINI neck	1
5	391000	Handle green/black complete with trigger	1
6	3912009	Trigger with spring	1
	391250	Micro switch complete (not shown)	1
7	381900	Cable support set with ball-and-socket joint	1
8	259163X8	Cable assembly 10ft (3mtr)	1
	259164X8	Cable assembly 13ft (4mtr)	1
	259165X8	Cable assembly 16ft (5mtr)	1
9	260019	Leather-sheathing with Velcro 10ft (3mtr)	1
10	340303	Fume extraction hose 30-38mm 10ft (3mtr)	1
	340304	Fume extraction hose 30-38mm 13ft (4mtr)	1
	340305	Fume extraction hose 30-38mm 16ft (5mtr)	1
11	398031	Hose connection	1
12	398100	Housing (Y-shape) for fume extraction hose	1
13	398015	Connection ring	1
14	398010	Housing set for central connector	1
15	305298E23	Central connector Euro	1
16	8M9420	Adaptor nut	2
17	305315	Liner positioner nut	10
18	398110	Hose adapter	1
19	406050	Gasflow meter	1
20	371208	Tool set (brush and multitool)	1
21	371350	Airflow meter MINI Extractor	1
-	320300	Ceramic dry film spray 400 ml (not shown)	12

EXTRACTION

8XE MINI 250 MIG EXTRACTOR (EURO)

CO2 - 280 AMP, MIXED GASES - 250 AMP, DUTY CYCLE - 100%



AIR COOLED

CLEAN AIR

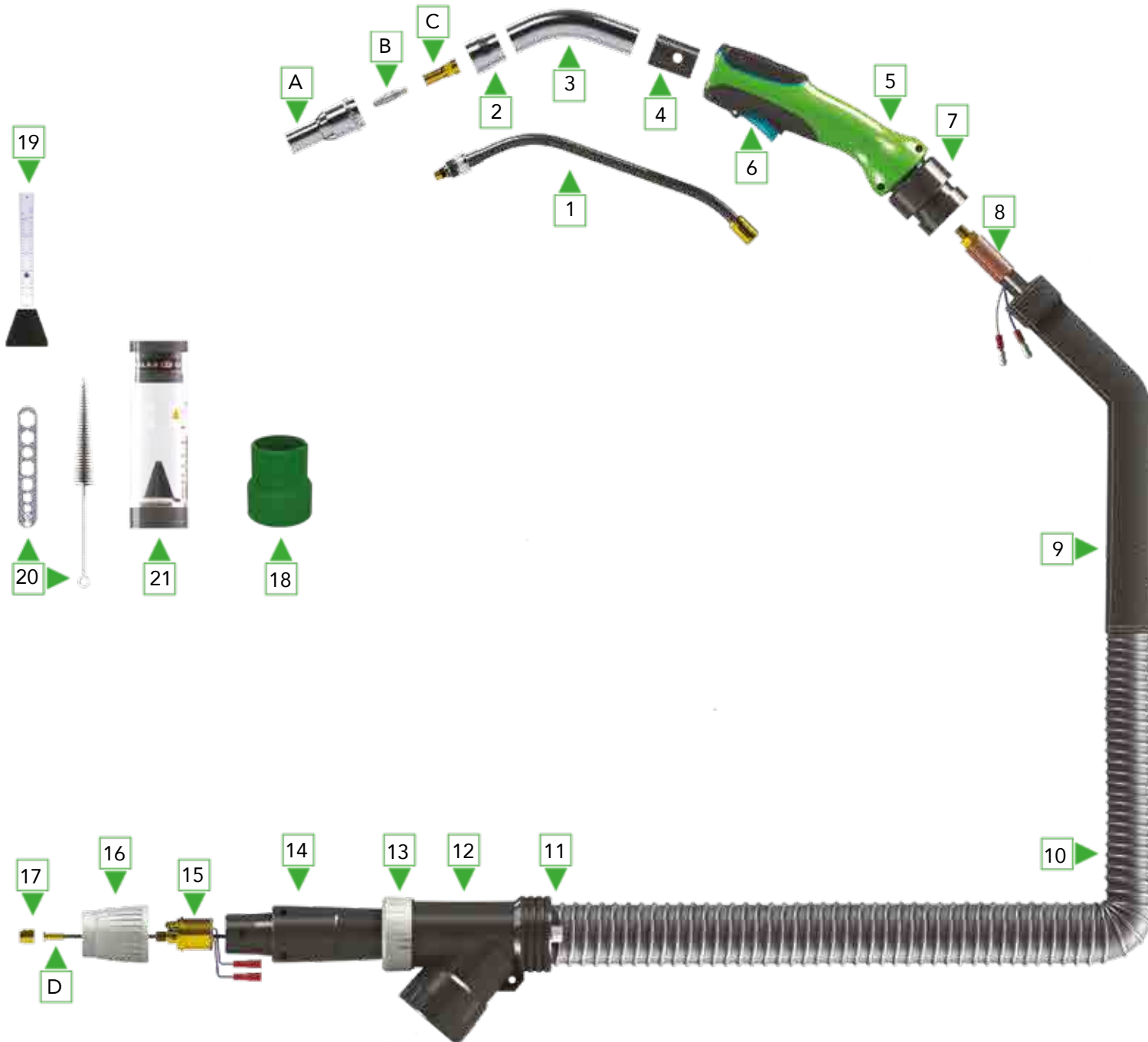

PART NO.	DESCRIPTION	PACK QTY
COMPLETE TORCHES		
8XO1000301000	8XE MINI Extractor 250AMP 10ft (3mtr) air cooled - 45° (standard)	1
8XO1000401000	8XE MINI Extractor 250AMP 13ft (4mtr) air cooled - 45° (standard)	1
8XO1000501000	8XE MINI Extractor 250AMP 16ft (5mtr) air cooled - 45° (standard)	1
8XO1500301000	8XE MINI Extractor 250AMP 10ft (3mtr) air cooled - Straight	1
8XO1500401000	8XE MINI Extractor 250AMP 13ft (4mtr) air cooled - Straight	1
8XO1500501000	8XE MINI Extractor 250AMP 16ft (5mtr) air cooled - Straight	1

ITEM	PART NO.	DESCRIPTION	PACK QTY
CONSUMABLES			
A	3937000	Nozzle conical 12mm	5
	3937001	Nozzle conical 14mm special	5
	3937002	Nozzle conical 14mm	5
B	399008	Contact Tip 8XR/8XE - .030 (0.8)	25
	399010	Contact Tip 8XR/8XE - .040 (1.0)	25
	399012	Contact Tip 8XR/8XE - .045 (1.2)	25
	3990102	Contact Tip 8XR/8XE - .040 (1.0) Alu	25
	3990122	Contact Tip 8XR/8XE - .045 (1.2) Alu	25
	3990091	Contact Tip 8XR/8XE - 0.35 (0.9) CuCrZr	25
	3990101	Contact Tip 8XR/8XE - .040 (1.0) CuCrZr	25
	3990121	Contact Tip 8XR/8XE - .045 (1.2) CuCrZr	25
C	39327110	Tip adapter	10
D	301535	Plastic coated liner blue 10ft (3mtr) - for .030 wire	1
	301545	Plastic coated liner blue 13ft (4mtr) - for .030 wire	1
	301555	Plastic coated liner blue 16ft (5mtr) - for .030 wire	1
	302535	Plastic coated liner red 10ft (3mtr) - for .030 wire	1
	302545	Plastic coated liner red 13ft (4mtr) - for .030 wire	1
	302555	Plastic coated liner red 16ft (5mtr) - for .030 wire	1
	301538	Teflon liner blue 10ft (3mtr) - for .030 wire	1
	301548	Teflon liner blue 13ft (4mtr) - for .030 wire	1
	301558	Teflon liner blue 16ft (5mtr) - for .030 wire	1
	302538	Teflon liner red 10ft (3mtr) - for .030 wire	1
	302548	Teflon liner red 13ft (4mtr) - for .030 wire	1
	302558	Teflon liner red 16ft (5mtr) - for .030 wire	1



ITEM	PART NO.	DESCRIPTION	PACK QTY
SPARE PARTS			
1	39301045	Swanneck 45°	1
	39301000	Swanneck straight	1
	3950005	PEEK ring to fix nozzle holder (not shown)	5
2	3950000	Nozzle holder	1
3	3950045	Metal neck 45°	1
	3950050	Metal neck straight	1
4	3950500	Adapter to fit MINI neck	1
5	391000	Handle green/black complete with trigger	1
6	3912009	Trigger with spring	1
	391250	Micro switch complete (not shown)	1
7	381900	Cable support set with ball-and-socket joint	1
8	259263X8	Cable assembly 10ft (3mtr)	1
	259264X8	Cable assembly 13ft (4mtr)	1
	259265X8	Cable assembly 16ft (5mtr)	1
9	260019	Leather-sheathing with Velcro 6ft (2mtr)	1
10	340303	Fume extraction hose 32-38mm 10ft (3mtr)	1
	340304	Fume extraction hose 32-38mm 13ft (4mtr)	1
	340305	Fume extraction hose 32-38mm 16ft (5mtr)	1
11	398031	Hose connection	1
12	398100	Housing (Y-shape) for fume extraction hose	1
13	398015	Connection ring	1
14	398010	Housing set for central connector	1
15	305298E23	Central connector Euro	1
16	8M9420	Adaptor nut	2
17	305315	Liner positioner nut	10
18	398110	Hose adapter	1
29	406050	Gasflow meter	1
20	371208	Tool set (brush and multitool)	1
21	371350	Airflow meter MINI Extractor	1
-	320300	Ceramic dry film spray 400 ml (not shown)	12

EXTRACTION

8XE MIG 400 EXTRACTOR (EURO)

CO2 - 420 AMP, MIXED GASES - 400 AMP, DUTY CYCLE - 100%



AIR COOLED

CLEAN AIR

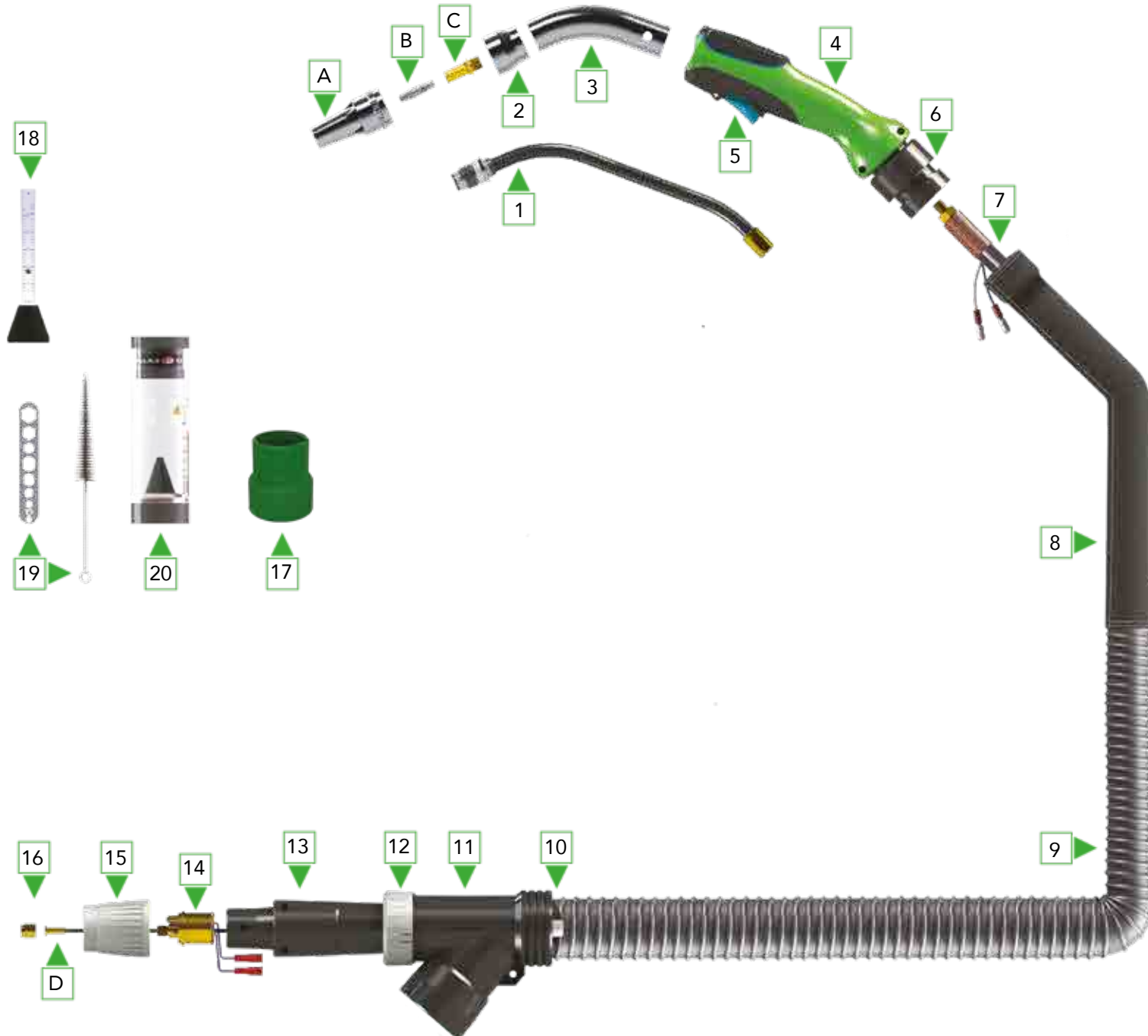

PART NO.	DESCRIPTION	PACK QTY
COMPLETE TORCHES		
8XO4028301000	8XE Extractor 400AMP 10ft (3mtr) air cooled - 45° (standard)	1
8XO4028401000	8XE Extractor 400AMP 13ft (4mtr) air cooled - 45° (standard)	1
8XO4028501000	8XE Extractor 400AMP 16ft (5mtr) air cooled- 45° (standard)	1
8XO4528301000	8XE Extractor 400AMP 10ft (3mtr) air cooled - Straight	1
8XO4528401000	8XE Extractor 400AMP 13ft (4mtr) air cooled - Straight	1
8XO4528501000	8XE Extractor 400AMP 16ft (5mtr) air cooled - Straight	1

ITEM	PART NO.	DESCRIPTION	PACK QTY
CONSUMABLES			
A	3937041	Nozzle 8XR/8XE Extractor 14mm special	5
	3937045	Nozzle 8XR/8XE Extractor 17mm special	5
B	399010	Contact Tip 8XR/8XE - 0.40 (1.0)	25
	399012	Contact Tip 8XR/8XE - 0.45 (1.2)	25
	399016	Contact Tip 8XR/8XE - 0.62 (1.6)	25
	3990102	Contact Tip 8XR/8XE - 0.40 (1.0) Alu	25
	3990122	Contact Tip 8XR/8XE - 0.45 (1.2) Alu	25
	3990091	Contact Tip 8XR/8XE - 0.35 (0.9) CuCrZr	25
	3990101	Contact Tip 8XR/8XE - 0.40 (1.0) CuCrZr	25
	3990121	Contact Tip 8XR/8XE - 0.45 (1.2) CuCrZr	25
	3990161	Contact Tip 8XR/8XE - 0.62 (1.6) CuCrZr	25
C	39327310	Tip adapter	10
D	303793	Plastic coated liner black 10ft (3mtr) - for .040 to .045 wire	1
	303794	Plastic coated liner black 13ft (4mtr) - for .040 to .045 wire	1
	303795	Plastic coated liner black 16ft (5mtr) - for .040 to .045 wire	1
	303763	Plastic coated liner grey 10ft (3mtr) - for .062 wire	1
	303764	Plastic coated liner grey 13ft (4mtr) - for .062 wire	1
	303765	Plastic coated liner grey 16ft (5mtr) - for .062 wire	1
	304830	Graphite liner black 10ft (3mtr) combiliner - for 1.0/1.2mm wire	1
	304831	Graphite liner black 13ft (4mtr) combiliner - for 1.0/1.2mm wire	1
	304832	Graphite liner black 16ft (5mtr) combiliner - for 1.0/1.2mm wire	1
	3048351	Graphite liner black 10ft (3mtr) combiliner - for 1.6mm wire	1
	3048361	Graphite liner black 13ft (4mtr) combiliner - for 1.6mm wire	1
	3048371	Graphite liner black 16ft (5mtr) combiliner - for 1.6mm wire	1



ITEM	PART NO.	DESCRIPTION	PACK QTY
SPARE PARTS			
1	39302145	Swanneck 45°	1
	39302100	Swanneck straight	1
	3950205	PEEK ring to fix nozzle holder (not shown)	5
2	3950200	Nozzle holder	1
3	3950245	Metal neck 45°	1
	3950250	Metal neck Straight	1
4	391000	Handle green/black complete with trigger	1
5	3912009	Trigger with spring	1
	391250	Micro switch complete (not shown)	1
6	381920	Cable support set with ball-and-socket joint	1
7	259463X8	Cable assembly 10ft (3mtr)	1
	259464X8	Cable assembly 13ft (4mtr)	1
	259465X8	Cable assembly 16ft (5mtr)	1
8	260018	Leather-sheathing with Velcro 6ft (2mtr)	1
9	3402032	Fume extraction hose 36-44mm 10ft (3mtr)	1
	3402042	Fume extraction hose 36-44mm 13ft (4mtr)	1
	3402052	Fume extraction hose 36-44mm 16ft (5mtr)	1
10	398030	Hose connection	1
11	398100	Housing (Y-shape) for fume extraction hose	1
12	398015	Connection ring	1
13	398010	Housing set for central connector	1
14	3052988	Central connector Euro	1
15	8M9420	Adaptor nut	2
16	305315	Liner positioner nut	10
17	398110	Hose adapter	1
18	406050	Gasflow meter	1
19	371208	Tool set (brush and multitool)	1
20	371300	Airflow meter Extractor	1
-	320300	Ceramic dry film spray 400 ml (not shown)	12

EXTRACTION

8XE 500 MIG EXTRACTOR (EURO)

CO2 - 550 AMP, MIXED GASES - 500 AMP, DUTY CYCLE - 100%



WATER COOLED

CLEAN AIR

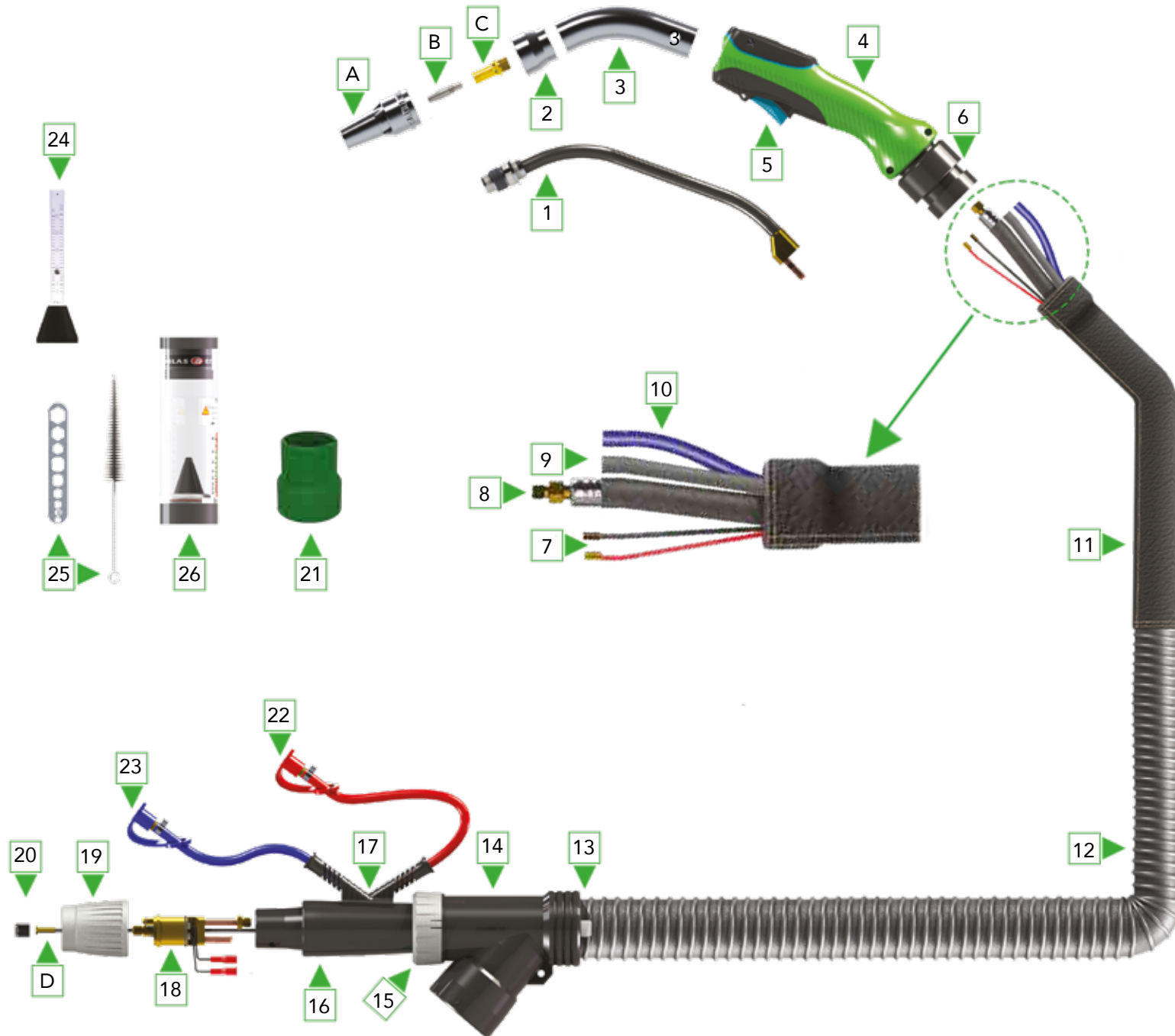

PART NO.	DESCRIPTION	PACK QTY
COMPLETE TORCHES		
8XO5060301000	8XE Extractor 500AMP 10ft (3mtr) water cooled - 45° (standard)	1
8XO5060401000	8XE Extractor 500AMP 13ft (4mtr) water cooled - 45° (standard)	1
8XO5060501000	8XE Extractor 500AMP 16ft (5mtr) water cooled - 45° (standard)	1
8XO5560301000	8XE Extractor 500AMP 10ft (3mtr) water cooled - Straight	1
8XO5560401000	8XE Extractor 500AMP 13ft (4mtr) water cooled - Straight	1
8XO5560501000	8XE Extractor 500AMP 16ft (5mtr) water cooled - Straight	1

ITEM	PART NO.	DESCRIPTION	PACK QTY
CONSUMABLES			
A	3937041	Nozzle 8XR/8XE Extractor 14mm special	5
	3937045	Nozzle 8XR/8XE Extractor 17mm special	5
B	399010	Contact Tip 8XR/8XE - 0.40 (1.0)	25
	399012	Contact Tip 8XR/8XE - 0.45 (1.2)	25
	399016	Contact Tip 8XR/8XE - 0.62 (1.6)	25
	3990102	Contact Tip 8XR/8XE - 0.40 (1.0) Alu	25
	3990122	Contact Tip 8XR/8XE - 0.45 (1.2) Alu	25
	3990091	Contact Tip 8XR/8XE - 0.35 (0.9) CuCrZr	25
	3990091	Contact Tip 8XR/8XE - 0.35 (0.9) CuCrZr	25
	3990101	Contact Tip 8XR/8XE - 0.40 (1.0) CuCrZr	25
	3990121	Contact Tip 8XR/8XE - 0.45 (1.2) CuCrZr	25
	3990161	Contact Tip 8XR/8XE - 0.62 (1.6) CuCrZr	25
C	39327210	Tip adapter	10
D	301535	Plastic coated liner blue 10ft (3mtr) - for 0.8mm wire	1
	301545	Plastic coated liner blue 13ft (4mtr) - for 0.8mm wire	1
	302555	Plastic coated liner red 16ft (5mtr) - for 1.0/1.2mm wire	1
	303635	Plastic coated liner red 10ft (3mtr) - for 1.6mm wire	1
	303645	Plastic coated liner red 13ft (4mtr) - for 1.6mm wire	1
	303655	Plastic coated liner red 16ft (5mtr) - for 1.6mm wire	1
	302538	Teflon red 10ft (3mtr) - for 1.0-1.2mm aluminium wire	1
	302548	Teflon red 13ft (4mtr) - for 1.0-1.2mm aluminium wire	1
	302558	Teflon red 16ft (5mtr) - for 1.0-1.2mm aluminium wire	1
	303638	Teflon red 10ft (3mtr) - for 1.6mm aluminium wire	1
	303648	Teflon red 13ft (4mtr) - for 1.6mm aluminium wire	1
	303658	Teflon red 16ft (5mtr) - for 1.6mm aluminium wire	1
	304830	Graphite liner black 10ft (3mtr) combiliner- for 1.0/1.2mm wire	1
	304831	Graphite liner black 13ft (4mtr) combiliner- for 1.0/1.2mm wire	1
	304832	Graphite liner black 16ft (5mtr) combiliner- for 1.0/1.2mm wire	1
	3048351	Graphite liner black 10ft (3mtr) combiliner- for 1.6mm wire	1
	3048361	Graphite liner black 13ft (4mtr) combiliner- for 1.6mm wire	1
	3048371	Graphite liner black 16ft (5mtr) combiliner- for 1.6mm wire	1



ITEM	PART NO.	DESCRIPTION	PACK QTY
SPARE PARTS			
1	39303045	Swanneck 45°	1
	39303000	Swanneck straight	1
	3950205	PEEK ring to fix nozzle holder (not shown)	5
2	3950200	Nozzle holder	1
3	3950245	Metal neck 45°	1
	39502250	Metal neck straight	1
4	391000	Handle green/black complete with trigger	1
5	3912009	Trigger with spring	1
	391250	Micro switch complete (not shown)	1
6	381920	Cable support set with ball-and-socket join	1
7	306505	Switch cable 1x0,75mm ² per mtr	100
8	258513X8	Power/water cable 10ft (3mtr)	1
	258514X8	Power/water cable 13ft (4mtr)	1
	258515X8	Power/water cable 5mtr	1
9	2585313XE	Outer liner 10ft (3mtr)	1
	2585314XE	Outer liner 13ft (4mtr)	1
	2585315XE	Outer liner 16ft (5mtr)	1
10	258535	Water inlet hose 5x8mm blue per mtr	100
	258566	Water outlet hose 5x8mm red per mtr	100
11	260018	Leather-sheathing with Velcro 6ft (3mtr)	1
12	3402032	Fume extraction hose 36-44mm 10ft (2mtr)	1
	3402042	Fume extraction hose 36-44mm 13ft (4mtr)	1
	3402052	Fume extraction hose 36-44mm 16ft (5mtr)	1
13	398030	Hose connection	1
14	398100	Housing (Y-shape) for fume extraction hose	1
15	398015	Connection ring	1
16	398010	Housing set for central connector	1
17	350881	Water hose guide	1
18	305304E23	Central connector Euro	1
19	8M9420	Adaptor nut	2
20	305315	Liner positioner nut	10
21	398110	Hose adapter	1
22	258701	Waterstop red	10
23	258702	Waterstop bluer	10
24	406050	Gasflow meter	1
25	371208	Tool set (brush and multitool)	1
26	371300	Airflow meter Extractor	1
-	320300	Ceramic dry film spray 400 ml (not shown)	12



8XE MIG EXTRACTOR

CONSUMABLES TO FIT YOUR SPECIFIC WELDING APPLICATION



CLEAN AIR

CONTACT TIPS

The specially designed nickel-plated contact tips for the complete 8XE MIG & 8XR Cobot Extractor series are designed for a longer lifetime.

You can choose from:

- Standard copper for everyday welding.
- Available in sizes from .030"(0.8mm) - .095" (2.4mm.)
- Special tips for aluminum welding.



NOZZLE OPTIONS

There are different nozzle variations to suit any kind of joint application while delivering the best welding results. The nozzles can be changed in a second.

MINI EXTRACTOR .47" (12mm)

The nozzle offers slightly more comprehensive shielding gas coverage on medium-thickness materials in butt and fillet applications as well as outside-corner joints.

8XE REGULAR / MINI .55" (14mm-Special)

Where space is limited and fit is tight, this nozzle offers better access and more excellent shielding gas coverage to prevent porosity. This 14mm special nozzle is delivered as a standard on every Extractor.

8XE REGULAR .67" (17mm-Special)

For heavier-thickness, high-current, and high-deposition butt and lap joint applications, this nozzle offers more excellent shielding gas coverage to prevent porosity.

TOP COVER MODULES

Pressure Relief is available option upon request.



Standard

Pressure Relief





8XE MIG EXTRACTOR

CONSUMABLES TO FIT YOUR SPECIFIC WELDING APPLICATION

MIG EXTRACTOR

WIRE FEED CONNECTORS

There are wire feed connectors available to fit any type of machine, including Tweco, Miller, Lincoln, and ESAB (Euro). Due to the design of the backend housing, you can switch between the connector types with ease.



MAINTENANCE



AIRFLOW METER

Always use the airflow meter to ensure maximum extraction effect.



GAS METER

The gas meter is used for best weld quality by keeping the right amount of shielding gas around the weld seam.



CERAMIC SPRAY

Prolong the life of your gun and all spare parts by applying the ceramic spray to the 8XE Extractor before work.

LINERS

Choose the right liner for your wire diameter and type when working with an 8XE Extractor:

Black: For .039" - .047" wire



Gray: For .062" wire



Green: For .078" - .094" wire



All liner types are suitable for stainless steel applications.

Blue: For .023" - .031" wire



Red: For .035" - .045" wire



Yellow: For .062" wire



EXTRACTION



EXTRACTION

TRANSLAS [®]
DUTCH WELDING TECHNOLOGY

8XR COBOT MIG EXTRACTOR





8XR COBOT MIG EXTRACTOR

SOURCE EXTRACTION

8XR COBOT

MADE FOR COBOT AND SEMI-AUTOMATIC SOLUTIONS

Certified By Universal Robots

SAFE & EFFECTIVE EXTRACTION OF WELDING FUMES DIRECTLY AT THE SOURCE.



CLEAN AIR

8XR MIG COBOT EXTRACTOR

The 8XR Cobot MIG Extractor integrates one of the most efficient fume extraction structures in the welding industry. The gun comes with four different angles 22°, 35°, 45° and straight.

The 8XR Cobot MIG Extractor, combined with the ClearO2 W-series 100 and 200, captures up to 98% of welding fumes directly at the source. The 8XR Cobot MIG Extractor provides one of the safest and most effective solutions for welders and workers to breathe CLEAN AIR and better work environments and works with the UR5e, UR10e & UR16e Universal Robot's.



CLEAN AIR





8XR COBOT MIG EXTRACTOR

REDUCES WELDING FUMES UP TO 98%

FEATURES

- ✓ ROBUST
- ✓ PATENTED
- ✓ UNIQUE CONTACT TIP FOR MAXIMUM DURABILITY
- ✓ VARIOUS GAS NOZZLES FOR BEST PERFORMANCE
- ✓ DESIGNED FOR ENLARGED ANGULAR MOVEMENT
- ✓ THE SWAN NECK IS SECURED IN TWO PLACES



HOW DOES IT WORK?

The 8XR MIG Extractor is specially made for Cobot and Semi-Automatic solutions. The 8XR is robust and the unique nozzle design combined with the ClearO2 W-series 100 and 200 provides the best results in taking away the fumes directly at the source. The specially designed nickel-plated contact tips are designed for a longer lifetime. The contact tips are available for all types of wire and sizes. The 8XR cobot works on the UR5e, UR10e and UR16e Universal Robots.



UR5e
5 kg | 11 lb
500 mm | 19.7 in

UR10e
10 kg | 22 lb
850 mm | 33.5 in

UR16e
16 kg | 35.3 lb
1300 mm | 51.2 in

UNIQUE NOZZLE DESIGN FOR OPTIMAL PERFORMANCE AND DURABILITY.

The nozzle design is unique to provide the best results. Openings, wall thickness and grip ribs are thoroughly developed for optimal operation and best performance.

WIRE FEED CONNECTORS

The 8XR MIG Extractor is as standard fitted with a EURO connector and like other Translas MIG lines available to fit any type of machine.

EXTRACTION





8XR COBOT MIG EXTRACTOR LINE

COBOT
EXTRACTOR



250

**AIR
COOLED
MINI**

8XR COBOT

CO2 - 280 AMP

Mixed Gases - 250 AMP

Duty Cycle - 100%



400

**AIR
COOLED**

8XR COBOT

CO2 - 420 AMP

Mixed Gases - 400 AMP

Duty Cycle - 100%



500

**WATER
COOLED**

8XR COBOT

CO2 - 550 AMP

Mixed Gases - 500 AMP

Duty Cycle - 100%

EXTRACTION

8XR MINI 250 COBOT MIG EXTRACTOR

CO2 - 280 AMP, MIXED GASES - 250 AMP, DUTY CYCLE - 100%

AIR COOLED

CLEAN AIR

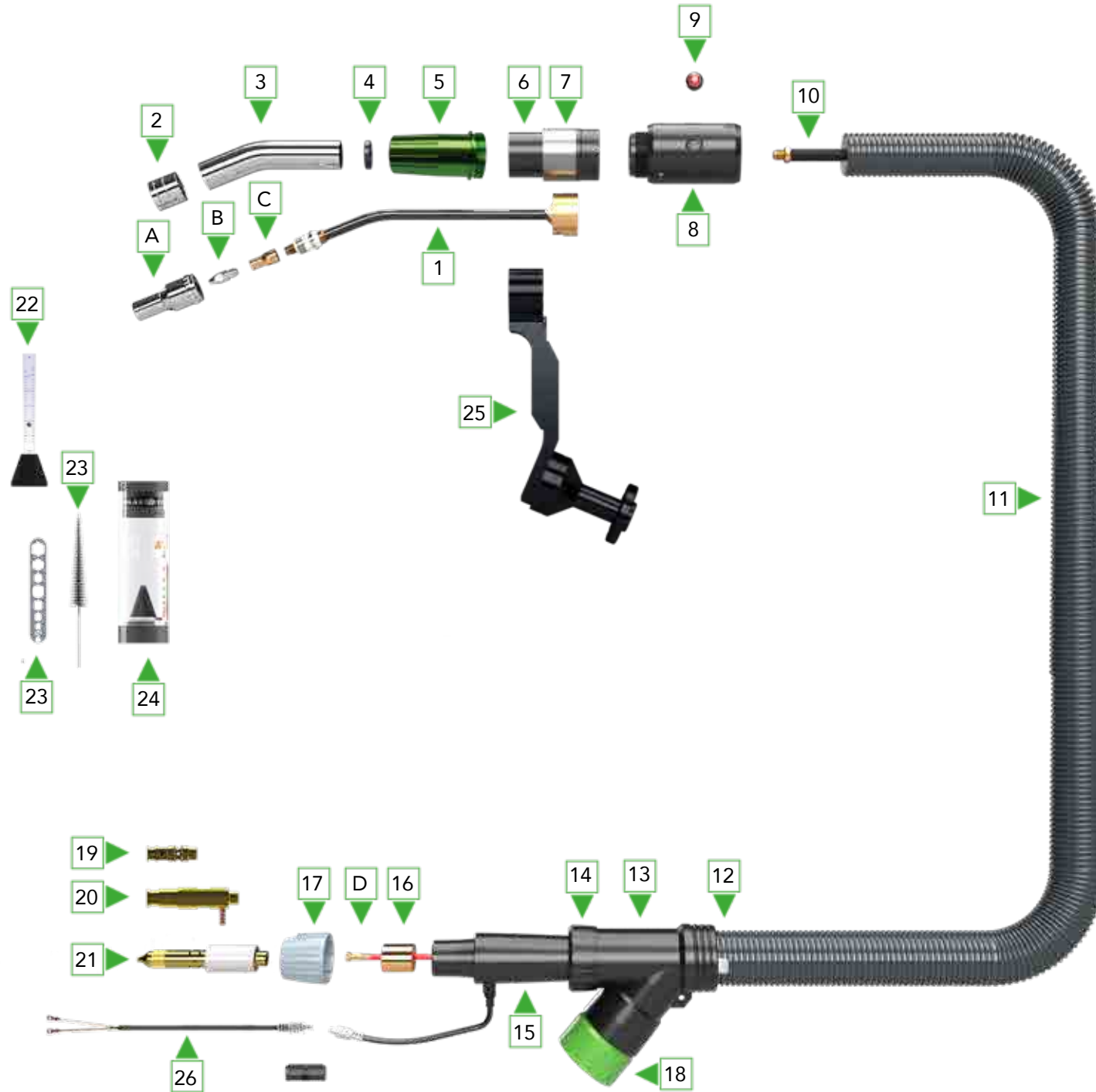

EXTRACTION

PART NO.	DESCRIPTION	PACK QTY
COMPLETE TORCHES		
Standard with external switch cable (item 24) connected to spring pins		
Standard without gun holder set (item 23)		1
8XR6200205081	8XR MINI Cobot Extractor 250AMP 6ft (2mtr) air cooled - 22° neck	1
8XR6200305081	8XR MINI Cobot Extractor 250AMP 10ft (3mtr) air cooled - 22° neck	1
8XR6200405081	8XR MINI Cobot Extractor 250AMP 13ft (4mtr) air cooled - 22° neck	1
8XR6400205081	8XR MINI Cobot Extractor 250AMP 6ft (2mtr) air cooled - 45° neck	1
8XR6400305081	8XR MINICobot Extractor 250AMP 10ft (3mtr) air cooled - 45° neck	1
8XR6400405081	8XR MINI Cobot Extractor 250AMP 13ft (4mtr) air cooled - 45° neck	1
8XR6000205081	8XR MINI Cobot Extractor 250AMP 6ft (2mtr) air cooled - Straight neck	1
8XR6000305081	8XR MINI Cobot Extractor 250AMP 10ft (3mtr) air cooled - Straight neck	1
8XR6000405081	8XR MINI Cobot Extractor 250AMP 13ft (4mtr) air cooled Straight neck	1
Additional options		
8XR*****90	Execution with Push-button switch connected to springpins (item 9)	
8XR*****91	Execution with Push-button switch connected to external connector (item 9 & 24)	

ITEM	PART NO.	DESCRIPTION	PACK QTY
CONSUMABLES			
A	3937000	Nozzle 8XR/8XE Extractor MINI 12mm	5
	3937001	Nozzle 8XR/8XE Extractor MINI 14mm special	5
	3937002	Nozzle 8XR/8XE Extractor MINI 14mm	5
	3937005	Nozzle 8XR/8XE Extractor MINI 17mm special	5
B	399008	Contact tip 8XR/8XE - 0.30 (0.8)	25
	399010	Contact tip 8XR/8XE - 0.40 (1.0)	25
	399012	Contact tip 8XR/8XE - 0.45 (1.2)	25
	3990102	Contact tip 8XR/8XE - 0.40 (1.0) Alu	25
	3990122	Contact tip 8XR/8XE - 0.45 (1.2) Alu	25
	3990091	Contact Tip 8XR/8XE - 0.35 (0.9) CuCrZr	25
	3990101	Contact tip 8XR/8XE - 0.40 (1.0) CuCrZr	25
	3990121	Contact tip 8XR/8XE - 0.45 (1.2) CuCrZr	25
C	39327110	8XR/8XE Tip adapter	10
D	301525	Plastic coated liner blue 6ft (2mtr) - for 0.8mm wire	1
	301535	Plastic coated liner blue 10ft (3mtr) - for 0.8mm wire	1
	301545	Plastic coated liner blue 13ft (4mtr) - for 0.8mm wire	1
	302525	Plastic coated liner red 6ft (2mtr) - for 1.0/1.2mm wire	1
	302535	Plastic coated liner red 10ft (3mtr) - for 1.0/1.2mm wire	1
	302545	Plastic coated liner red 13ft (4mtr) - for 1.0/1.2mm wire	1
	304829	Graphite liner black 6ft (2mtr) combiliner- for 1.0/1.2mm wire	1
	304830	Graphite liner black 10ft (3mtr) combiliner - for 1.0/1.2mm wire	1
	304831	Graphite liner black 13ft (4mtr) combiliner - for 1.0/1.2mm wire	1



ITEM	PART NO.	DESCRIPTION	PACK QTY
SPARE PARTS			
1	3980122	8XR Swanneck MINI 22°	1
	3980145	8XR Swanneck MINI 45°	1
	3980100	8XR Swanneck MINI straight	1
	3950005	PEEK ring for 8XR/8XE swanneck MINI (not shown)	5
2	3950100	8XR Nozzle holder MINI	1
3	3980522	8XR Metal neck 22°	1
	39502453	8XR Metal neck 45° (partnumber 3980601 is needed)	1
	3980601	8XR Metal neck connector for 45° neck	1
	3980500	8XR Metal neck straight	1
4	3980490	8XR Centre ring for swanneck MINI	1
5	39804411	8XR Adapter metal neck green	1
6	3980400	8XR Torch body	1
7	3980405	8XR Centre bush	1
	3980410	8XR Centre screw M4 (not shown - 3 pieces is needed)	5
8	3980700	8XR Connection set	1
9	3501575	Push-button switch red	2
10	259262XR	Cozx cable 8XR MINI 6ft (2mtr)	1
	259263XR	Cozx cable 8XR MINI 10ft (3mtr)	1
	259264XR	Cozx cable 8XR MINI 13ft (4mtr)	1
11	3402022	Fume cover hose 8XR/8XE 6ft (2mtr)	1
	3402032	Fume cover hose 8XR/8XE 10ft (3mtr)	1
	3402042	Fume cover hose 8XR/8XE 13ft (4mtr)	1
12	398030	Hose connection	1
13	398100	Housing (Y-shape) for fume extraction hose	1
14	398015	Connection ring	1
15	398010	Housing set for central connector	1
16	3059001	Central connector air cooled USA	1
17	398200	Adaptor nut USA	2
18	398110	Hose adapter	10
19	3059100	Tweco tail	1
20	3059200S	Lincoln tail complete with gashose	1
21	3059150	Miller tail	1
22	406050	Gasflow meter	1
23	371208	Tool set (brush and multitool)	1
24	371350	Airflow meter 8XE/8XR Extractor MINI	1
25	3991022	8XR Torchholder set 22°	1
26	Please ask	Push Button connection (also in combination with item 9)	1

8XR COBOT MIG 400 EXTRACTOR

CO2 - 420 AMP, MIXED GASES - 400 AMP, DUTY CYCLE - 100%



AIR COOLED

CLEAN AIR

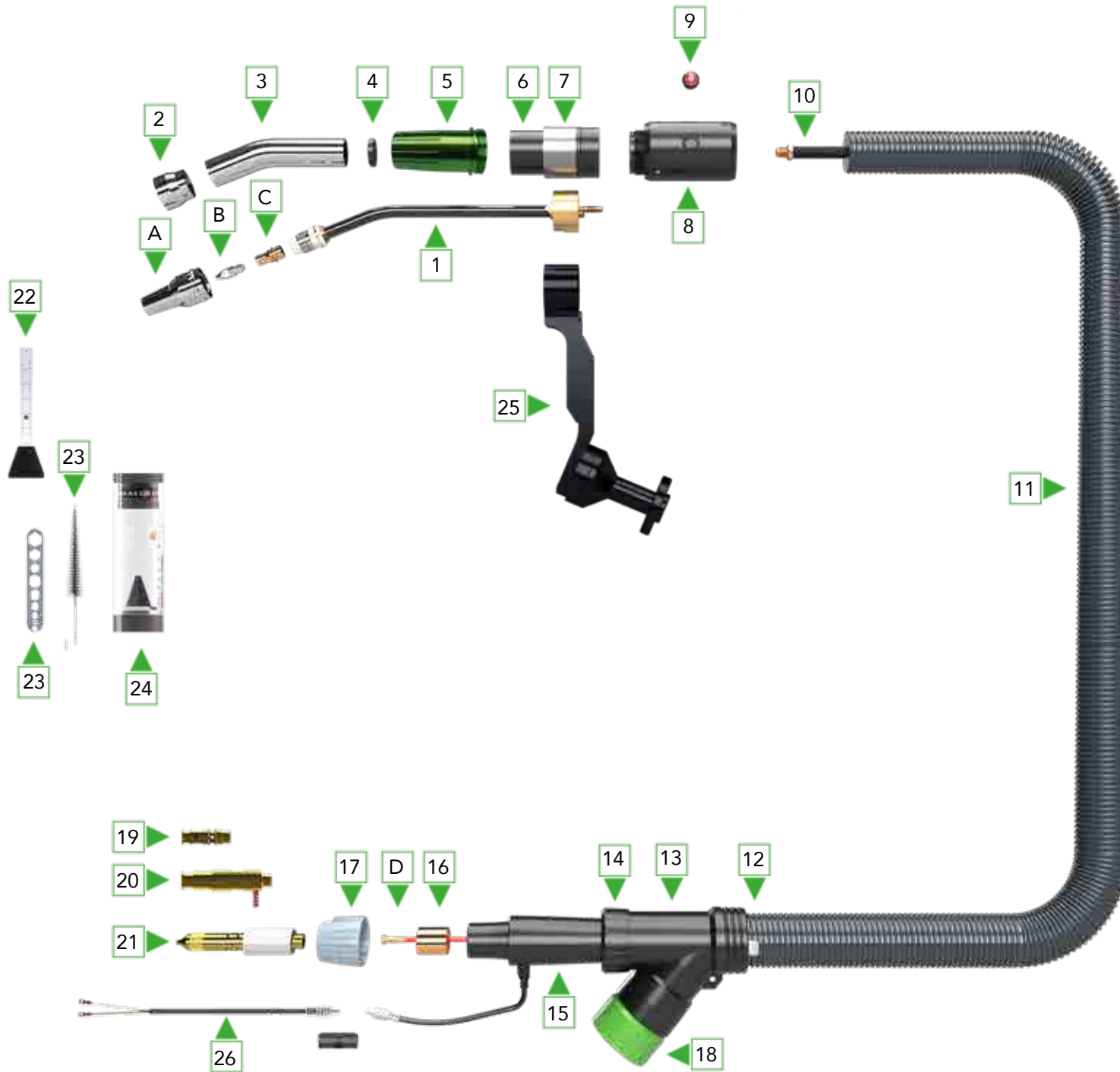

EXTRACTION

PART NO.	DESCRIPTION	PACK QTY
COMPLETE TORCHES		
	Standard with external switch cable (item 28) connected to spring pins	
	Standard without gun holder set (item 27)	
8XR7228205081	8XR Cobot MIG Extractor 400 AMP 6ft (2mtr) air cooled - 22° neck	1
8XR7228305081	8XR Cobot MIG Extractor 400AMP 10ft (3mtr) air cooled - 22° neck	1
8XR7228405081	8XR Cobot MIG Extractor 400AMP 13ft (4mtr) air cooled - 22° neck	1
8XR7428205081	8XR Cobot MIG Extractor 400AMP 6ft (2mtr) air cooled - 45° neck	1
8XR7428305081	8XR Cobot MIG Extractor 400AMP 10ft (3mtr) air cooled - 45° neck	1
8XR7428405081	8XR Cobot MIG Extractor A400AMP 13ft (4mtr) air cooled - 45° neck	1
8XR7028205081	8XR Cobot MIG Extractor 400AMP 6ft (2mtr) air cooled - St. neck	1
8XR7028305081	8XR Cobot MIG Extractor 400AMP 10ft (3mtr) air cooled - St. neck	1
8XR7028405081	8XR Cobot MIG Extractor 400AMP13ft (4mtr) air cooled - St. neck	1
8XR*****90	Execution with Push-button switch connected to springpins (item 9)	
8XR*****91	Execution with Push-button switch connected to external connector (item 9 & 29)	

ITEM	PART NO.	DESCRIPTION	PACK QTY
CONSUMABLES			
A	3937041	Nozzle 8XR/8XE Extractor .55 (14mm) special	5
	3937045	Nozzle 8XR/8XE Extractor .67 (17mm) special	5
B	399010	Contact Tip 8XR/8XE - 0.40 (1.0)	25
	399012	Contact Tip 8XR/8XE - 0.45 (1.2)	25
	399016	Contact Tip 8XR/8XE - 0.62 (1.6)	25
	3990102	Contact Tip 8XR/8XE - 0.40 (1.0) Alu	25
	3990122	Contact Tip 8XR/8XE - 0.45 (1.2) Alu	25
	3990091	Contact Tip 8XR/8XE - 0.35 (0.9) CuCrZr	25
	3990101	Contact Tip 8XR/8XE - 0.40 (1.0) CuCrZr	25
	3990121	Contact Tip 8XR/8XE - 0.45 (1.2) CuCrZr	25
	3990161	Contact Tip 8XR/8XE - 0.62 (1.6) CuCrZr	25
	3990201	Contact Tip 8XR/8XE - 0.78 (2.0) CuCrZr	25
	3990241	Contact Tip 8XR/8XE - 0.95 (2.4) CuCrZr	25
C	39327310	8XR/8XE Tip adapter	10
D	303792	Plastic coated liner black 6ft (2m) - for .040 to .045 wire	1
	303793	Plastic coated liner black 10ft (3m) - for .040 to .045 wire	1
	303794	Plastic coated liner black 13ft (4m) - for .040 to .045 wire	1
	303762	Plastic coated liner grey 6ft (2m) - for .062 wire	1
	303763	Plastic coated liner grey 10ft (3m) - for .062 wire	1
	303764	Plastic coated liner grey 13ft (4m) - for .062 wire	1
	304829	Graphite liner black 6ft (2m) combiliner - for .030 to .045 wire	1
	304830	Graphite liner black 10ft (3m) combiliner - for .030 to .045 wire	1
	304831	Graphite liner black 13ft (4m) combiliner - for .030 to .045 wire	1
	3048341	Graphite liner black 6ft (2m) combiliner - for .062 wire	1
	3048351	Graphite liner black 10ft (3m) combiliner - for .062 wire	1
	3048361	Graphite liner black 13ft (4m) combiliner - for .062 wire	1



ITEM	PART NO.	DESCRIPTION	PACK QTY
SPARE PARTS			
1	3980322	8XR Swanneck 22°	1
	3980345	8XR Swanneck 45°	1
	3980300	8XR Swanneck straight	1
	3950005	PEEK ring for 8XR/8XE swanneck (not shown)	5
2	3950200	8XR Nozzle holder	1
3	3980522	8XR Metal neck 22°	1
	39502453	8XR Metal neck 45° (partnumber 3980601 is needed)	1
	3980601	8XR Metal neck connector for 45° neck	1
	3980500	8XR Metal neck straight	1
4	3980480	8XR Centre ring for swanneck	1
5	39804411	8XR Adapter metal neck green	1
6	3980400	8XR Torch body	1
7	3980405	8XR Centre bush	1
	3980410	8XR Centre screw M4 (not shown - 3 pieces is needed)	5
8	3980700	8XR Connection set	1
9	3501575	Push-button switch red	2
10	259462XR	Cozx cable 8XR 6.6ft (2mtr)	1
	259463XR	Cozx cable 8XR 10.0ft (3mtr)	1
	259464XR	Cozx cable 8XR 13.1ft (4mtr)	1
11	3402022	Fume cover hose 8XR/8XE 6ft (2mtr)	1
	3402032	Fume cover hose 8XR/8XE 10ft (3mtr)	1
	3402042	Fume cover hose 8XR/8XE 13ft (4mtr)	1
12	398030	Hose connection	1
13	398100	Housing (Y-shape) for fume extraction hose	1
14	398015	Connection ring	1
15	398010	Housing set for central connector	1
16	30590012	Central connector air cooled USA	1
17	398200	Adaptor nut USA	2
18	398110	Hose adapter	10
19	3059100	Tweco tail	1
20	30592005	Lincoln tail complete with gashose	1
21	3059150	Miller tail	1
22	406050	Gasflow meter	1
23	371208	Tool set (brush and multitool)	1
24	371300	Airflow meter 8XE/8XR Extractor	1
25	3991022	8XR Torchholder set 22°	1
26	Please ask	Push Button connection (also in combination with item 9)	1

8XR COBOT MIG 500 EXTRACTOR

CO2 - 550 AMP, MIXED GASES - 500 AMP, DUTY CYCLE - 100%



WATER COOLED

CLEAN AIR

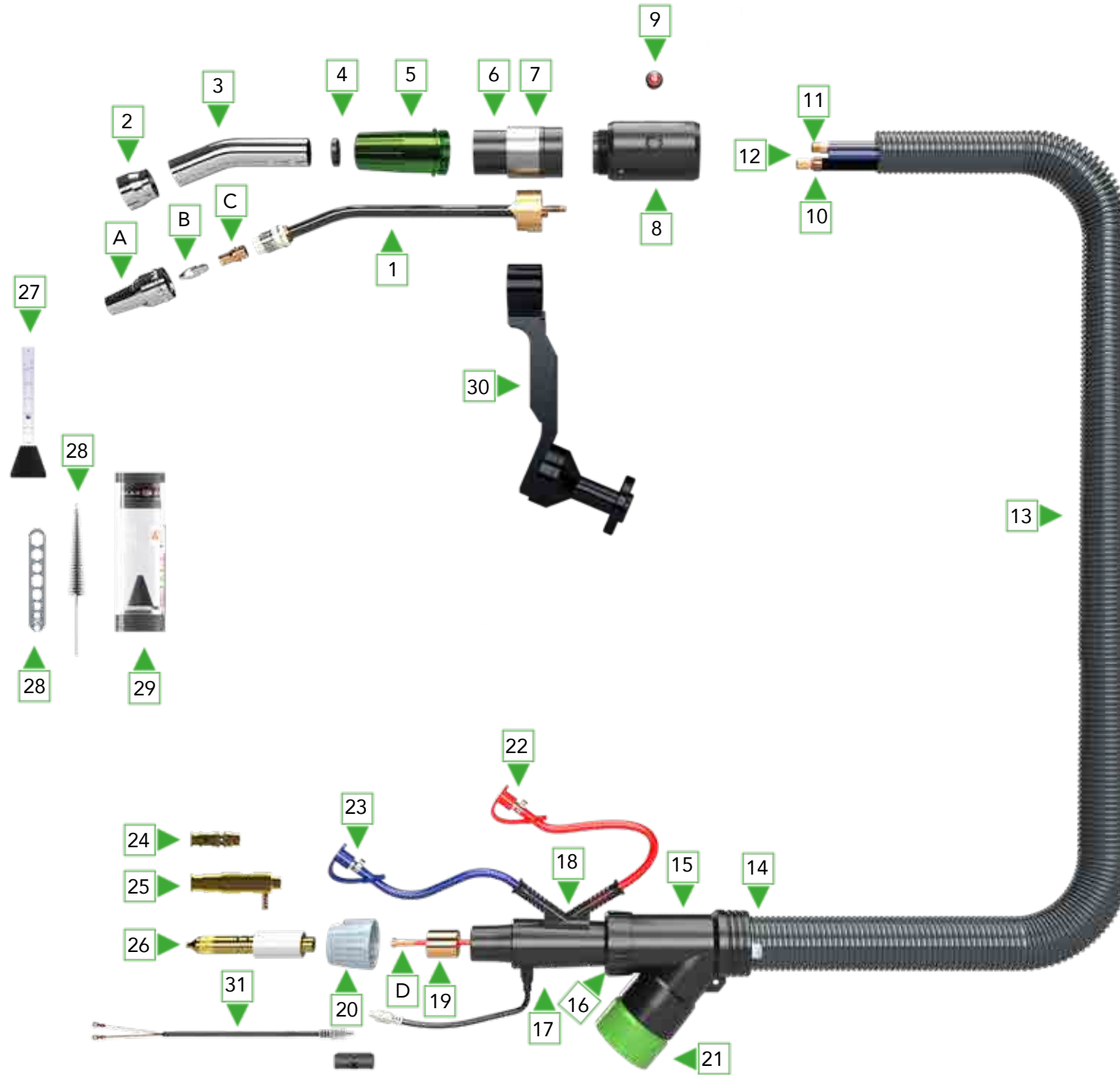

EXTRACTION

PART NO.	DESCRIPTION	PACK QTY
COMPLETE TORCHES		
	Standard with external switch cable (item 29) connected to spring pins	
	Standard without torch holder set (item 28)	
8XR9260205081	8XR Cobot MIG Extractor 500AMP 6ft (2m) water cooled - 22° neck	1
8XR9260305081	8XR Cobot MIG Extractor 500AMP10 (3m) water cooled - 22° neck	1
8XR9260405081	8XR Cobot MIG Extractor 500AMP 13ft (4m) water cooled - 22° neck	1
8XR9460205081	8XR Cobot MIG Extractor 500AMP 6ft (2m) water cooled - 45° neck	1
8XR9460305081	8XR Cobot MIG Extractor 500AMP 10ft (3m) water cooled - 45° neck	1
8XR9460405081	8XR Cobot MIG Extractor 500AMP 13ft (4m) water cooled - 45° neck	1
8XR9060205081	8XR Cobot MIG Extractor 500AMP 6ft (2m) water cooled - St. neck	1
8XR9060305081	8XR Cobot MIG Extractor 500AMP 10ft (3m) water cooled - St. neck	1
8XR9060405081	8XR Cobot MIG Extractor 500AMP 13ft (4m) water cooled - St. neck	1
8XR*****90	Execution with Push-button switch connected to springpins (item 9)	
8XR*****91	Execution with Push-button switch connected to external connector (item 9 & 29)	

ITEM	PART NO.	DESCRIPTION	PACK QTY
CONSUMABLES			
A	3937041	Nozzle 8XR/8XE Extractor 14mm special	5
	3937045	Nozzle 8XR/8XE Extractor 17mm special	5
B	399008	Contact tip 8XR/8XE - 0.30 (0,8)	25
	399010	Contact tip 8XR/8XE - 0.40 (1,0)	25
	399012	Contact tip 8XR/8XE - 0.45 (1,2)	25
	399016	Contact tip 8XR/8XE - 0.62 (1,6)	25
	3990102	Contact tip 8XR/8XE - 0.40 (1,0) Alu	25
	3990122	Contact tip 8XR/8XE - 0.45 (1,2) Alu	25
	3990091	Contact Tip 8XR/8XE - 0.35 (0,9) CuCrZr	25
	3990101	Contact tip 8XR/8XE - 0.40 (1,0) CuCrZr	25
	3990121	Contact tip 8XR/8XE - 0.45 (1,2) CuCrZr	25
	3990161	Contact tip 8XR/8XE - 0.62 (1,6) CuCrZr	25
C	39327210	8XR/8XE Tip adapter	10
D	301525	Plastic coated liner blue 6ft (2mtr) - for 0.8mm wire	1
	301535	Plastic coated liner blue 10ft (3mtr) - for 0.8mm wire	1
	301545	Plastic coated liner blue 13ft (4mtr) - for 0.8mm wire	1
	302525	Plastic coated liner red 6ft (2mtr) - for 1.0/1.2mm wire	1
	302535	Plastic coated liner red 10ft (3mtr) - for 1.0/1.2mm wire	1
	302545	Plastic coated liner red 13ft (4mtr) - for 1.0/1.2mm wire	1
	303625	Plastic coated liner yellow 6ft (2mtr) - for 1.6mm wire	1
	303635	Plastic coated liner yellow 10ft (3mtr) - for 1.6mm wire	1
	303645	Plastic coated liner yellow 13ft (4mtr) - for 1.6mm wire	1
	304829	Graphite liner black 6ft (2mtr) combiliner - for 1.0/1,2mm wire	1
	304830	Graphite liner black 10ft (3mtr) combiliner - for 1.0/1,2mm wire	1
	304831	Graphite liner black 13ft (4mtr) combiliner - for 1.0/1,2mm wire	1
	3048341	Graphite liner black 6ft (2mtr) combiliner - for 1.6mm wire	1
	3048351	Graphite liner black 10ft (3mtr) combiliner - for 1.6mm wire	1
	3048361	Graphite liner black 13ft (4mtr) combiliner - for 1.6mm wire	1



ITEM	PART NO.	DESCRIPTION	PACK QTY
SPARE PARTS			
1	3980022	8XR Swanneck water cooled 22°	1
	3980045	8XR Swanneck water cooled 45°	1
	3980000	8XR Swanneck water cooled straight	1
	3950205	PEEK ring for 8XR/8XE swanneck air/water (not shown)	5
2	3950200	Nozzle holder for 8XR/8XE Nozzle	1
3	3980522	8XR Metal neck 22°	1
	39502453	8XR Metal neck 45° (partnumber 3980601 is needed)	1
	3980601	8XR Metal neck connector for 45° neck	1
	3980500	8XR Metal neck straight	1
4	3980480	8XR Centre ring for swanneck	1
5	39804411	8XR Adapter metal neck green	1
6	3980400	8XR Torch body	1
7	3980405	8XR Centre bush	1
	3980410	8XR Centre screw M4 (not shown - 3 pieces is needed)	5
8	3980700	8XR Connection set	1
9	3501575	Push-button switch red	2
10	258512X8R	Power/water cable 8XR/8XE 6.6ft (2mtr)	1
	258513X8R	Power/water cable 8XR/8XE 10.0ft (3mtr)	1
	258514X8R	Power/water cable 8XR/8XE 13.1ft (4mtr)	1
11	2585312XR	Outer liner 8XR/8XE 6.6ft (2mtr)	1
	2585313XR	Outer liner 8XR/8XE 10.0ft (3mtr)	1
	2585314XR	Outer liner 8XR/8XE 13.1ft (4mtr)	1
12	258535	Water inlet hose 5x8mm blue per mtr	100
	258566	Water outlet hose 5x8mm red per mtr	100
13	3402022	Fume cover hose 8XR/8XE 36-44mm 6ft (2mtr)	1
	3402032	Fume cover hose 8XR/8XE 36-44mm 10ft (3mtr)	1
	3402042	Fume cover hose 8XR/8XE 36-44mm 13ft (4mtr)	1
14	398030	Hose connection	1
15	398100	Housing (Y-shape) for fume extraction hose	1
16	398015	Connection ring	1
17	398010	Housing set for central connector	1
18	350881	Water hose guide	1
19	3059002	Central connector water cooled USA	1
20	398200	Adaptor nut USA	1
21	398110	Hose adapter	1
22	258701	Waterstop red	10
23	258702	Waterstop blue	10
24	3059100	Tweco tail	1
25	3059200S	Lincoln tail complete with gashose	1
26	3059150	Miller tail	1
27	406050	Gasflow meter	1
28	371208	Tool set (brush and multitool)	1
29	371300	Airflow meter 8XE/8XR Extractor	1
30	3991022	8XR Torchholder set 22°	1
31	Please ask	Push Button connection (also in combination with item 10)	1





8XR COBOT MIG EXTRACTOR

CONSUMABLES TO FIT YOUR SPECIFIC WELDING APPLICATION

**COBOT
EXTRACTOR**

The specially designed nickel-plated contact tips for the complete 8XR Cobot & 8XE MIG Extractor series are designed for a longer lifetime.

CONTACT TIPS



You can choose from:

- Standard copper for everyday welding.
- Available in sizes from .030" (0.8mm) - .095" (2.4mm.)
- Special tips for aluminum welding.

WIRE FEED CONNECTORS

There are wire feed connectors available to fit any type of machine, including Tweco, Miller, Lincoln, and ESAB (Euro). Due to the design of the backend housing, you can switch between the connector types with ease.



FREE DRIVE BUTTON

MAINTENANCE

AIRFLOW METER

Always use the Airflow meter to ensure maximum extraction effect.

GAS METER

The gas meter is used for best weld quality by keeping the right amount of shielding gas around the weld seam.

CERAMIC SPRAY

Prolong the life of your gun and all spare parts by applying the ceramic spray to the 8XE and 8XR Extractor before work.



NOZZLE OPTIONS

There are different nozzle variations to suit any kind of joint application and deliver best welding results. The nozzles can be changed in a second.

8XR & 8XE REGULAR

14mm-Special

Where space is limited and fit is tight, this nozzle offers better access and more excellent shielding gas coverage to prevent porosity. This 14mm special nozzle is delivered as a standard on every extractor torch.



8XR & 8XE REGULAR

17mm-Special

For heavier-thickness, high-current and high-deposition butt and lap joint applications, this nozzle offers more excellent shielding gas coverage to prevent porosity.



LINERS

Choose the right liner for your wire diameter and type when working with a 8XE & 8XR Extractor Torch:



All liner types are suitable for stainless steel applications. For Aluminium application, there are the following types:

Blue, Red and Yellow in Teflon and Graphite.

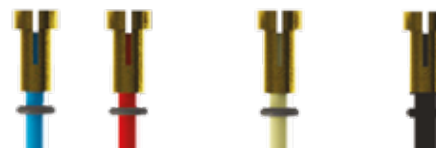



TRANSLAS [®]
DUTCH WELDING TECHNOLOGY

8TE TIG EXTRACTOR

EXTRACTION

HARMFUL PARTICULATE ELIMINATED, ONLY CLEAN AIR





8TE TIG EXTRACTOR



CLEAN AIR

SOURCE EXTRACTION

The 8TE TIG Extractor offers break through integrated at-source fume extraction for the TIG welding process.

DID YOU KNOW?

Stainless steel and aluminum welding produces the most toxic particulates that are found in the harmful welding fumes because of hexavalent chromium and manganese.

VARIOUS SWITCH MODULES AVAILABLE

Positioned at approximately 5 degrees, the switch module eliminates any tension in the fingers and minimizes the risk of cramps due to daily repetitive movements.

EXTREMELY FLEXIBLE HOSE ON FIRST 3' (METRE)

The 8TE Extractor has an extremely flexible vacuum hose specifically the first 1 meter (3') from the handle

**Reduces
Welding Fumes
up to 95%**

**Standard
TIG
Consumables**

CLEAN AIR





8TE TIG EXTRACTOR

TIG EXTRACTOR

THE NEW 8TE-17 AND 8TE-30 TIG EXTRACTORS

Our TIG Extractors protect the welders and other workers in the factory from harmful fumes and metals like aluminum, chromium, iron, manganese, and nickel which are released during the welding process.

SAME CONVENIENT HANDLE AS REGULAR 8XT GUN

The 8TE TIG Extractor handle has a unique ergonomic shape designed to suit the shape of the welder's hand, fitting perfectly between the thumb and index fingers. The grip is made out of a durable but soft 2K TPE rubber. Both the ergonomic shape and the grip material contribute to the excellent stability of the gun during the welding process.



CLEARO2 T100 / T200

The ClearO2 T100 and T200 portable extraction units offered by Translas are especially engineered to work with the 8TE TIG Extractor to deliver the best results - up to 95% extraction of #welding harmful particulate directly at the source.



PRODUCT FEATURES

- ✓ SOURCE CAPTURE FUME EXTRACTION.
- ✓ EXTRACTS UP TO 95% OF HARMFUL WELDING FUMES AND TOXIC PARTICULATES DIRECTLY AT THE SOURCE BEFORE AIRBORNE.
- ✓ ERGONOMIC GRIP/HANDLE ALL-DAY COMFORT AND STABILITY FOR THE WELDER.
- ✓ EXTRACTION NOZZLE FROM PPS WITH AN ALUMINUM RADIATION PROTECTION SHIELD AND INTERCHANGEABLE PARTS.
- ✓ EXTREMELY FLEXIBLE SUCTION HOSE.
- ✓ OPTIONAL: FLAME RETARDANT PROTECTION HOSE.
- ✓ ROTATING CONNECTION COUPLER.
- ✓ CABLE SUPPORT BEHIND Y-PIECE.
- ✓ EFFECTIVE SUCTION FLOW BETWEEN 18-20M³.
- ✓ TIG AIRFLOW METER – CAN BE USED WITH ALL TIG GUNS.

PCB PROTECTION PLATE

The PCB module is fixed and completely covered by a protection plate, which keep the PCB safe from harmful fumes and dirt. The unique gold-plated spring contacts ensure perfect connection with the welding machine.



EXTRACTION



EXTRACTION



8TE TIG EXTRACTOR LINE

TIG
EXTRACTOR



8TE TIG EXTRACTOR

17 AIR
COOLED

DC - 140 AMP

AC/DC - 100 AMP

Duty Cycle - 35%



8TE TIG EXTRACTOR

30 WATER
COOLED

DC - 320 AMP

AC/DC - 230 AMP

Duty Cycle - 100%



8TE TIG EXTRACTOR

35 WATER
COOLED

DC - 320 AMP

AC/DC - 230 AMP

Duty Cycle - 100%

EXTRACTION



8TE-17 TIG EXTRACTOR

DC - 140 AMP, AC/DC - 100 AMP, DUTY CYCLE - 35%



CLEAN AIR

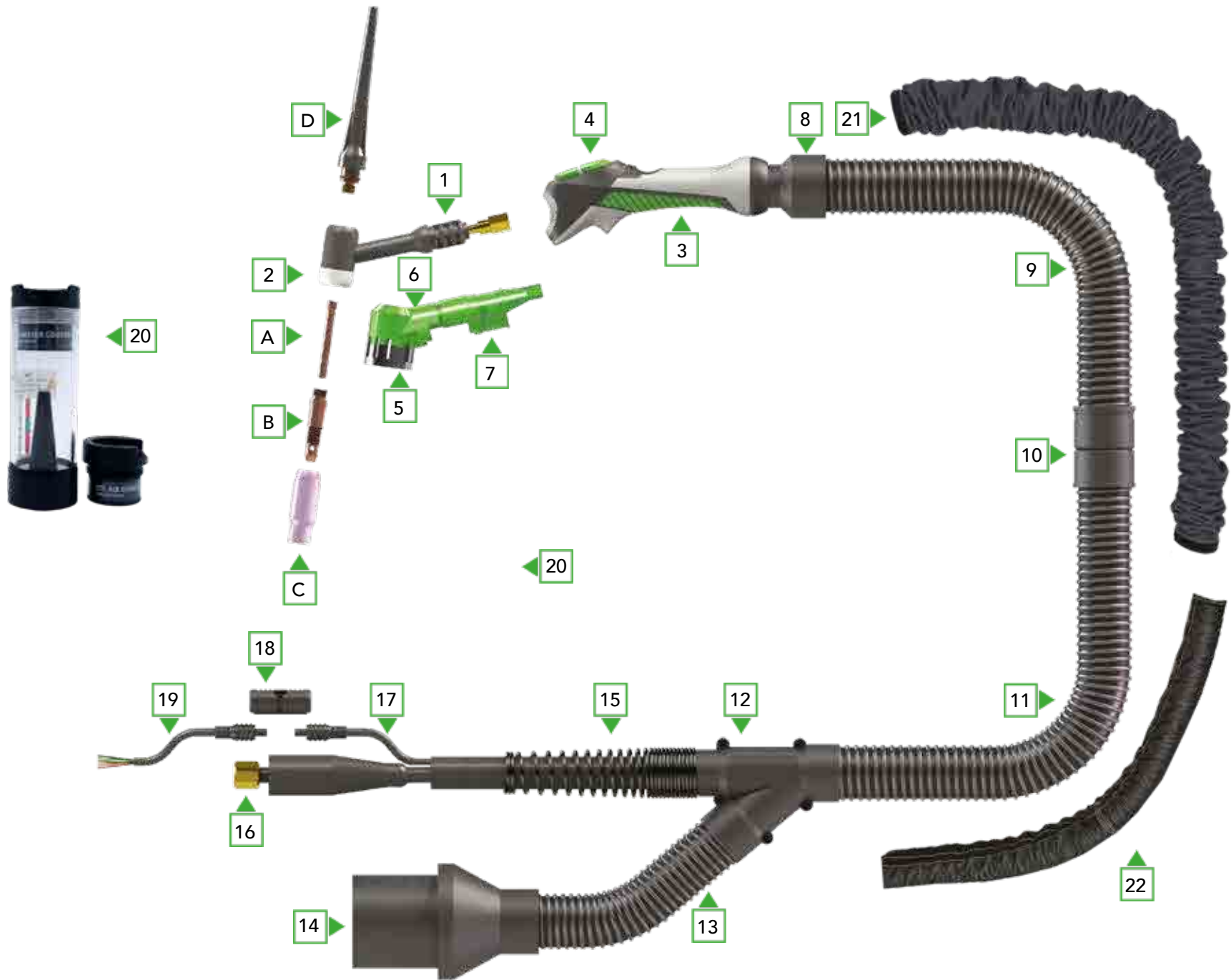

PART NO.	DESCRIPTION	PACK QTY
COMPLETE TORCHES		
8TE20010504350	8TE-17 Tig Extractor 13ft (4mtr) 10-25mm ² +1/4'G	1
8TE20010508350	8TE-17 Tig Extractor 26ft (8mtr) 10-25mm ² +1/4'G	1
8TE20010504370	8TE-17 Tig Extractor 13ft (4mtr) 35-50mm ² +1/4'G	1
8TE20010508370	8TE-17 Tig Extractor 26ft (8mtr) 35-50mm ² +1/4'G	1
8TE20010504340	8TE-17 Tig Extractor 13ft (4mtr) CA Fronius 35-50mm ²	1
8TE20010508340	8TE-17 Tig Extractor 26ft (8mtr) CA Fronius 35-50mm ²	1
8TE20010504000	8TE-17 Tig Extractor 13ft (4mtr) M12x1	1
8TE20010508000	8TE-17 Tig Extractor 26ft (8mtr) M12x1	1
8TE20010504210	8TE-17 Tig Extractor 13ft (4mtr) 1/4'G	1
8TE20010508210	8TE-17 Tig Extractor 26ft (8mtr) 1/4'G	1
8TE20010504220	8TE-17 Tig Extractor 13ft (4mtr) 3/8'G	1
8TE20010508220	8TE-17 Tig Extractor 26ft (8mtr) 3/8'G	1

These 8TE guns come as a standard with a one-button switch module and a trigger cable end without the plug. For other switch options and triggers cable end with plug, refer to pages 54 and 55.



ITEM	PART NO.	DESCRIPTION	PACK QTY
CONSUMABLES			
A	500664	10N22 Collet 1.0mm	5
	006666	10N23 Collet 1.6mm	5
	500668	70062 Collet 2.0mm	5
	500670	10N24 Collet 2.4mm	5
	500674	10N25 Collet 3.2mm	5
	500676	54N20 Collet 4.0mm	5
B	500764	10N30 Collet body 1.0mm	5
	500766	10N31 Collet body 1.6mm	5
	500768	70064 Collet body 2.0mm	5
	500770	10N32 Collet body 2.4mm	5
	500774	10N28 Collet body 3.2mm	5
	500776	406488 Collet body 4.0mm	5
C	500520	10N50 Ceramic cup 6.4mm	10
	500522	10N49 Ceramic cup 7.9mm	10
	500524	10N48 Ceramic cup 9.5mm	10
	500526	10N47 Ceramic cup 11.1mm	10
	500530	10N46 Ceramic cup 12.7mm	10
	500530	10N45 Ceramic cup 16.0mm	10
	500532	10N44 Ceramic cup 19.0mm	10
D	500346	57Y02 Back cap long	5
	500347	300M Back cap medium	5

ITEM	PART NO.	DESCRIPTION	PACK QTY
SPARE PARTS			
1	520200	Gun body air cooled	1
2	500402	18CG Heat shield	5
3	8X9987	Handle green complete with 1-button switch	1
	580150	Inside handle stop (Not shown)	1
	580160	Inside hose stop (Not shown)	2
4	8X9518	Switch module green 1-button complete	1
		For other switch options we refer to page 55	
5	581010	Heat shield aluminium	1
6	5803502	Suction head	1
7	5801002	Torchbody adaptor	1
8	581050	Ball-and-socket joint	1
9	580400	Suction hose front 3ft (1mtr) black	1
	442352	Suction hose cover 3ft (1mtr) (not shown)	1
10	5810602	Connection part for 25mm hose (for 13ft/4mtr gun)	1
	5810622	Connection part for 30mm hose (for 26ft/8mtr gun)	1
11	340102	Suction hose 25mm black p/mtr (for 13ft/4mtr gun)	1 _{mtr}
	340505	Suction hose 30mm black p/mtr (for 26ft/8mtr gun)	1 _{mtr}
12	5802002	Y-Piece set	1
	5802202	Inside stop to block suction smoke (Not shown)	1
	580250	Adaptor to fit 30mm hose on Y-Piece (When torch is 8mtr)	1
13	340102	Suction hose 25mm black p/mtr	1 _{mtr}
14	581068	Adaptor Suction hose 25mm -> 56mm	1
	581069	Adaptor Suction hose 25mm -> 38mm	1
15	580215	Spring 27mm for Y-Piece	1
16		Power/Water cable On request as this is depending on machine connection	1
17	306550	Switch cable 13ft (4mtr) (QuickConnect)	1
	306552	Switch cable 26ft (8mtr) (QuickConnect)	1
18	306545	Locking clip (QuickConnect)	1
19	306559	Switch cable end without plug (QuickConnect)	1
20	585000	Airflow meter Extractor	1
21	442352	Hose Cover (Optional)	1
22	5820004	Leather cover for 13ft (4mtr) gun (optional)	1
23	260027	Leather cover for 26ft (8mtr) gun (optional)	1

For other Switch cable ends with plug, we refer to Page 54

8TE-30 TIG EXTRACTOR

DC - 320 AMP, AC/DC - 330 AMP, DUTY CYCLE - 100%



WATER COOLED

CLEAN AIR

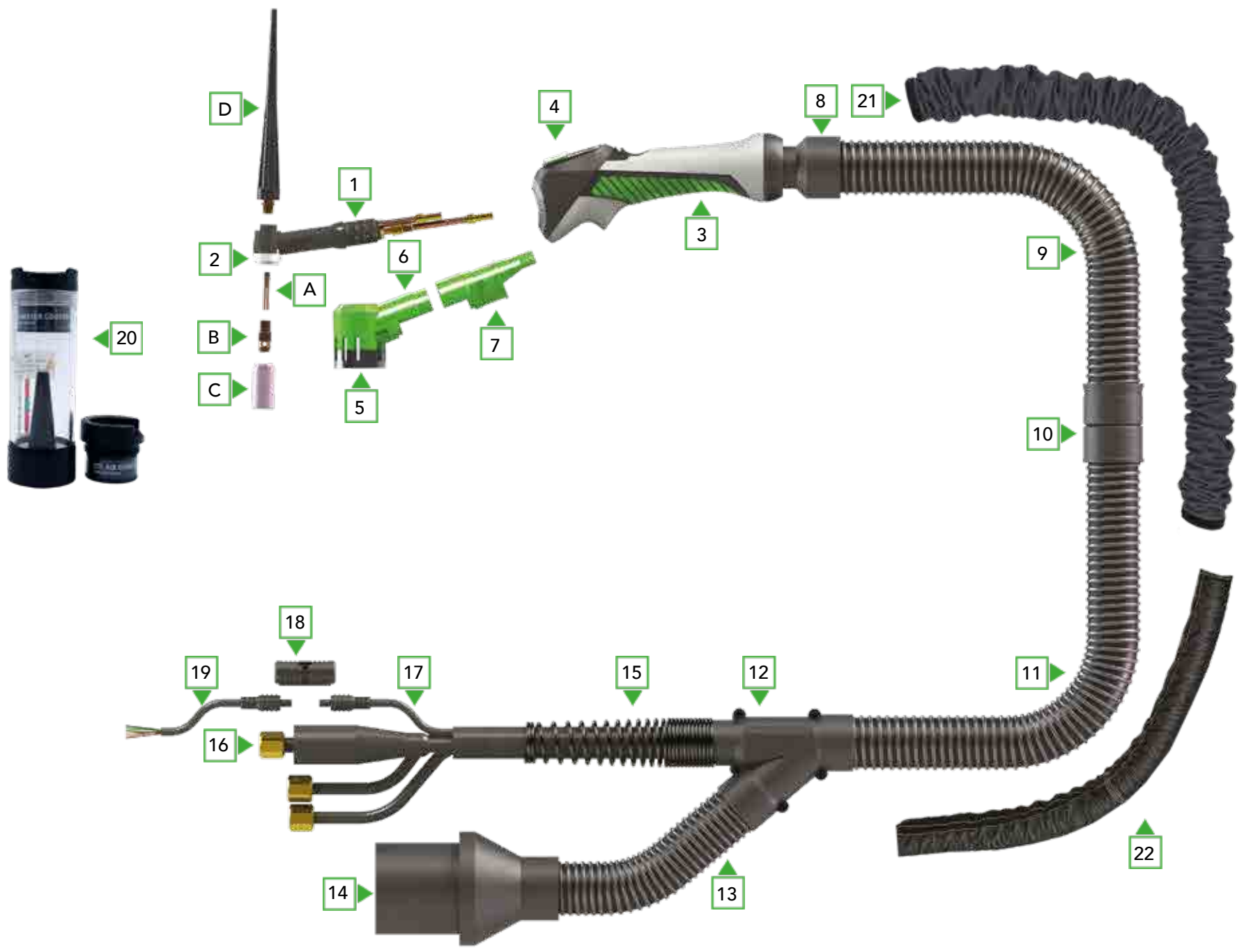

PART NO.	DESCRIPTION	PACK QTY
COMPLETE TORCHES		
8TE60014704650	8TE-30 Tig Extractor 13ft (4mtr) 35-50mm ² +tules+1/4'G	1
8TE60014708650	8TE-30 Tig Extractor 26ft (8mtr) 35-50mm ² +tules+1/4'G	1
8TE60014704990	8TE-30 Tig Extractor 13ft (4mtr) CA Fronius 35-50mm ² +tules	1
8TE60014708990	8TE-30 Tig Extractor 26ft (8mtr) CA Fronius 35-50mm ² +tules	1
8TE60014704600	8TE-30 Tig Extractor 13ft (4mtr) M12x1+3/8'G+1/4'G	1
8TE60014708600	8TE-30 Tig Extractor 26ft (8mtr) M12x1+3/8'G+1/4'G	1
8TE60014704800	8TE-30 Tig Extractor 13ft (4mtr) 3/8'G+3/8'G+1/4'G	1
8TE60014708800	8TE-30 Tig Extractor 26ft (8mtr) 3/8'G+3/8'G+1/4'GG	1

These 8TE guns come as a standard with a one-button switch module and a trigger cable end without the plug. For other switch options and triggers cable end with plug, refer to pages 54 and 55.

ITEM	PART NO.	DESCRIPTION	PACK QTY
CONSUMABLES			
A	500650	13N20 Collet 0.5mm	5
	500652	13N21 Collet 1.0mm	5
	500654	13N22 Collet 1.6mm	5
	500656	70066 Collet 2.0mm	5
	500658	13N23 Collet 2.4mm (standard)	5
	500660	13N24 Collet 3.2mm	5
B	500750	13N25 Collet body 0.5mm	5
	500752	13N26 Collet body 1.0mm	5
	500754	13N27 Collet body 1.6mm	5
	500756	70067 Collet body 2.0mm	5
	500758	13N28 Collet body 2.4mm (standard)	5
	500760	13N29 Collet body 3.2mm	5
C	500500	13N08 Ceramic cup 6.4mm Gr. 4	10
	500502	13N09 Ceramic cup 7.9mm Gr. 5	10
	500504	13N10 Ceramic cup 9.5mm Gr. 6 (standard)	10
	500506	13N11 Ceramic cup 11.1mm Gr. 7	10
	500508	13N12 Ceramic cup 12.7mm Gr. 8	10
	500510	13N13 Ceramic cup 15.9mm Gr. 10	10
D	500344	41V35 Back cap medium	5
	500340	41V24 Back cap long (standard)	5



ITEM	PART NO.	DESCRIPTION	PACK QTY
SPARE PARTS			
1	520700	Gun body water cooled	1
2	500400	598882 Heat shield	5
3	8X9987	Handle green complete with 1-button switch	1
	580150	Inside handle stop (Not shown)	1
	580160	Inside hose stop (Not shown)	2
4	8X9518	Switch module green 1-button complete	1
		For other switch options we refer to page 55	
5	581000	Heat shield aluminium	1
6	5803002	Suction head	1
7	5801002	Torchbody adaptor	1
8	581050	Ball-and-socket joint	1
9	580400	Suction hose front 3ft (1mtr) black	1
	442352	Suction hose cover 3ft (1mtr) (not shown)	1
10	5810602	Connection part for 25mm hose (for 13ft/4mtr gun)	1
	5810622	Connection part for 30mm hose (for 26ft/8mtr gun)	1
11	340102	Suction hose 25mm black p/mtr (for 13ft/4mtr gun)	1 ^{mtr}
	340505	Suction hose 30mm black p/mtr (for 26ft/8mtr gun)	1 ^{mtr}
12	5802002	Y-Piece set	1
	5802202	Inside stop to block suction smoke (Not shown)	1
	580250	Adaptor to fit 30mm hose on Y-Piece (for 26ft/8mtr gun)	1
13	340102	Suction hose 25mm black p/mtr	1 ^{mtr}
14	581068	Adaptor Suction hose 25mm -> 56mm	1
	581069	Adaptor Suction hose 25mm -> 38mm	1
15	580215	Spring 27mm for Y-Piece	1
16		Power/Water cable On request as this is depending on machine connection	1
17	306550	Switch cable 13ft (4mtr) (QuickConnect)	1
	306552	Switch cable 26ft (8mtr) (QuickConnect)	1
18	306545	Locking clip (QuickConnect)	1
19	306559	Switch cable end without plug (QuickConnect)	1
20	585000	Airflow meter Extractor	1
21	442352	Hose Cover (Optional)	1
22	5820004	Leather cover for 13ft (4mtr) gun (optional)	1
23	260027	Leather cover for 26ft (8mtr) gun (optional)	1

For other Switch cable ends with plug, we refer to Page 54

8TE-35 TIG EXTRACTOR

DC - 320 AMP, AC/DC - 330 AMP, DUTY CYCLE - 100%



WATER COOLED

CLEAN AIR

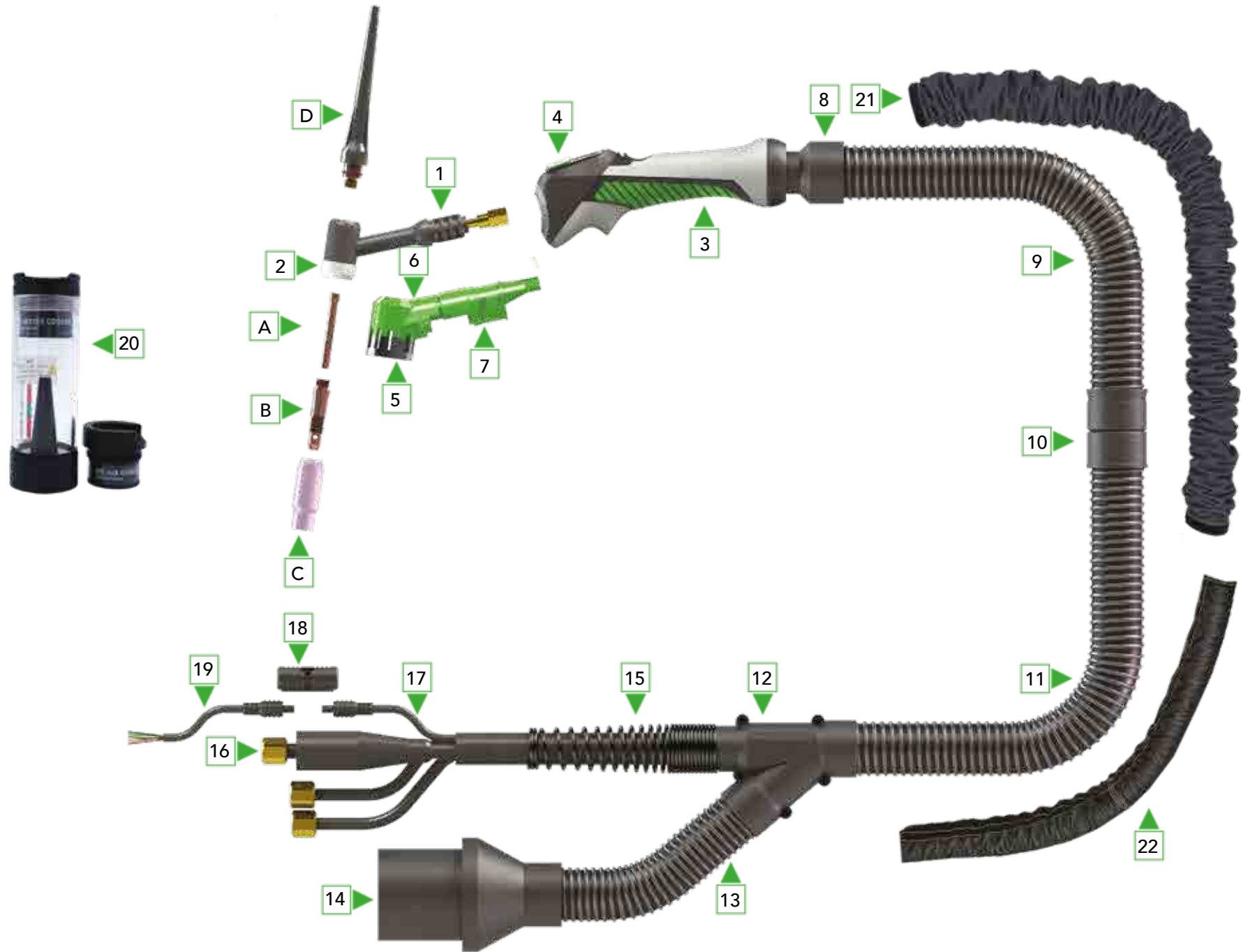

PART NO.	DESCRIPTION	PACK QTY
COMPLETE TORCHES		
8TE65014704650	8TE-35 Tig Extractor 13ft (4mtr) 35-50mm ² +tules+1/4'G	1
8TE65014708650	8TE-35 Tig Extractor 26ft (8mtr) 35-50mm ² +tules+1/4'G	1
8TE65014704990	8TE-35 Tig Extractor 13ft (4mtr) CA Fronius 35-50mm ² +tules	1
8TE65014708990	8TE-35 Tig Extractor 26ft (8mtr) CA Fronius 35-50mm ² +tules	1
8TE65014704600	8TE-35 Tig Extractor 13ft (4mtr) M12x1+3/8'G+1/4'G	1
8TE65014708600	8TE-35 Tig Extractor 26ft (8mtr) M12x1+3/8'G+1/4'G	1
8TE65014704800	8TE-35 Tig Extractor 13ft (4mtr) 3/8'G+3/8'G+1/4'G	1
8TE65014708800	8TE-35 Tig Extractor 26ft (8mtr) 3/8'G+3/8'G+1/4'GG	1

These 8TE torches come as a standard with a one-button switch module and a trigger cable end without the plug. For other switch options and triggers cable end with plug, we refer to pages 54 and 55.

ITEM	PART NO.	DESCRIPTION	PACK QTY
CONSUMABLES			
A	500664	10N22 Collet 1.0mm	5
	006666	10N23 Collet 1.6mm	5
	500668	70062 Collet 2.0mm	5
	500670	10N24 Collet 2.4mm	5
	500674	10N25 Collet 3.2mm	5
	500676	54N20 Collet 4.0mm	5
B	500764	10N30 Collet body 1.0mm	5
	500766	10N31 Collet body 1.6mm	5
	500768	70064 Collet body 2.0mm	5
	500770	10N32 Collet body 2.4mm	5
	500774	10N28 Collet body 3.2mm	5
	500776	406488 Collet body 4.0mm	5
C	500520	10N50 Ceramic cup 6.4mm	10
	500522	10N49 Ceramic cup 7.9mm	10
	500524	10N48 Ceramic cup 9.5mm	10
	500526	10N47 Ceramic cup 11.1mm	10
	500530	10N46 Ceramic cup 12.7mm	10
	500530	10N45 Ceramic cup 16.0mm	10
	500532	10N44 Ceramic cup 19.0mm	10
D	500346	57Y02 Back cap long	5
	500347	300M Back cap medium	5



ITEM	PART NO.	DESCRIPTION	PACK QTY
SPARE PARTS			
1	520701	Torch body water cooled	1
2	500402	18CG Heat shield	5
3	8X9987	Handle green complete with 1-button switch	1
	580150	Inside handle stop (Not shown)	1
	580160	Inside hose stop (Not shown)	2
4	8X9518	Switch module green 1-button complete	1
		For other switch options we refer to page 54	
5	581000	Heat shield aluminium	1
6	5804102	Suction head	1
7	5801002	Torchbody adaptor	1
8	581050	Ball-and-socket joint	1
9	580400	Suction hose front 1mtr black	1
	442352	Suction hose cover 1mtr (Not shown)	1
10	5810602	Connection part for 25mm hose (When torch is 4mtr)	1
	5810622	Connection part for 30mm hose (When torch is 8mtr)	1
11	340102	Suction hose 25mm black p/mtr (When torch is 4mtr)	1mtr
	340505	Suction hose 30mm black p/mtr (When torch is 8mtr)	1mtr
12	5802002	Y-Piece set	1
	5802202	Inside stop to block suction smoke (Not shown)	1
	580250	Adaptor to fit 30mm hose on Y-Piece (When torch is 8mtr)	1
13	340102	Suction hose 25mm black p/mtr	1mtr
14	581068	Adaptor Suction hose 25mm -> 56mm	1
	581069	Adaptor Suction hose 25mm -> 38mm	1
15	580215	Spring 27mm for Y-Piece	1
16		Power/Water cable On request as this is depending on machine connection	1
17	306550	Switch cable 4mtr (QuickConnect)	1
	306552	Switch cable 8mtr (QuickConnect)	1
18	306545	Locking clip (QuickConnect)	1
19	306559	Switch cable end without plug (QuickConnect)	1
20	585000	Airflow meter Extractor	1
21	442352	Hose Cover (Optional)	1
22	5820004	Leather Cover for 4mtr torch (optional)	1
23	260027	Leather Cover for 8mtr torch (optional)	1

For other Switch cable ends with plug, we refer to Page 54



8TE TIG EXTRACTOR



CLEAN AIR

SWITCH CABLE ENDS



CONFIGURATION SHEET

With this configuration sheet, you can easily select the plug applicable for the various welding machines. You can also select the switch types and water- or gas-cooled applications.

ITEM	PART NO.	MACHINE BRAND	PLUG TYPE	GAS COOLED	WATER COOLED	ONE BUTTON	TWO BUTTON	THREE BUTTON	FOUR BUTTON
1	507541	Cebora	10-pins Cebora	<input checked="" type="checkbox"/>	<input checked="" type="checkbox"/>	<input checked="" type="checkbox"/>	<input checked="" type="checkbox"/>	<input checked="" type="checkbox"/>	<input checked="" type="checkbox"/>
	507549	Cebora	10-pins Cebora	<input checked="" type="checkbox"/>	<input checked="" type="checkbox"/>	<input checked="" type="checkbox"/>	<input checked="" type="checkbox"/>	<input checked="" type="checkbox"/>	<input checked="" type="checkbox"/>
2	507450	Esab	2-pins Amphenol	<input checked="" type="checkbox"/>	<input checked="" type="checkbox"/>	<input checked="" type="checkbox"/>	<input checked="" type="checkbox"/>	<input checked="" type="checkbox"/>	<input checked="" type="checkbox"/>
	5004623	EWM, Lincoln, Saf Oerlikon	5-pins Tüchel	<input checked="" type="checkbox"/>	<input checked="" type="checkbox"/>	<input checked="" type="checkbox"/>	<input checked="" type="checkbox"/>	<input checked="" type="checkbox"/>	<input checked="" type="checkbox"/>
3	507714	EWM	8-pins UTG	<input checked="" type="checkbox"/>	<input checked="" type="checkbox"/>	<input checked="" type="checkbox"/>	<input checked="" type="checkbox"/>	<input checked="" type="checkbox"/>	<input checked="" type="checkbox"/>
	507552	Jäckle	5-pins Tüchel	<input checked="" type="checkbox"/>	<input checked="" type="checkbox"/>	<input checked="" type="checkbox"/>	<input checked="" type="checkbox"/>	<input checked="" type="checkbox"/>	<input checked="" type="checkbox"/>
4	507550	Jäckle	5-pins Tüchel	<input checked="" type="checkbox"/>	<input checked="" type="checkbox"/>	<input checked="" type="checkbox"/>	<input checked="" type="checkbox"/>	<input checked="" type="checkbox"/>	<input checked="" type="checkbox"/>
	507561	Jäckle	7-pins Tüchel	<input checked="" type="checkbox"/>	<input checked="" type="checkbox"/>	<input checked="" type="checkbox"/>	<input checked="" type="checkbox"/>	<input checked="" type="checkbox"/>	<input checked="" type="checkbox"/>
5	50048227	Fronius	9-pins Fronius	<input checked="" type="checkbox"/>	<input checked="" type="checkbox"/>	<input checked="" type="checkbox"/>	<input checked="" type="checkbox"/>	<input checked="" type="checkbox"/>	<input checked="" type="checkbox"/>
	50048247	Fronius	9-pins Fronius	<input checked="" type="checkbox"/>	<input checked="" type="checkbox"/>	<input checked="" type="checkbox"/>	<input checked="" type="checkbox"/>	<input checked="" type="checkbox"/>	<input checked="" type="checkbox"/>
6	507435	Kemppi	4-pins Amphenol	<input checked="" type="checkbox"/>	<input checked="" type="checkbox"/>	<input checked="" type="checkbox"/>	<input checked="" type="checkbox"/>	<input checked="" type="checkbox"/>	<input checked="" type="checkbox"/>
	5075371	Kemppi	7-pins Amphenol MLS	<input checked="" type="checkbox"/>	<input checked="" type="checkbox"/>	<input checked="" type="checkbox"/>	<input checked="" type="checkbox"/>	<input checked="" type="checkbox"/>	<input checked="" type="checkbox"/>
7	5075372	Kemppi	7-pins Amphenol MLS	<input checked="" type="checkbox"/>	<input checked="" type="checkbox"/>	<input checked="" type="checkbox"/>	<input checked="" type="checkbox"/>	<input checked="" type="checkbox"/>	<input checked="" type="checkbox"/>
	5075373	Kemppi	7-pins Amphenol MLS	<input checked="" type="checkbox"/>	<input checked="" type="checkbox"/>	<input checked="" type="checkbox"/>	<input checked="" type="checkbox"/>	<input checked="" type="checkbox"/>	<input checked="" type="checkbox"/>
8	5075374	Kemppi	7-pins Amphenol MLS	<input checked="" type="checkbox"/>	<input checked="" type="checkbox"/>	<input checked="" type="checkbox"/>	<input checked="" type="checkbox"/>	<input checked="" type="checkbox"/>	<input checked="" type="checkbox"/>
	507611	Migatron	7-pins Amphenol	<input checked="" type="checkbox"/>	<input checked="" type="checkbox"/>	<input checked="" type="checkbox"/>	<input checked="" type="checkbox"/>	<input checked="" type="checkbox"/>	<input checked="" type="checkbox"/>
9	507621	Migatron	7-pins Amphenol	<input checked="" type="checkbox"/>	<input checked="" type="checkbox"/>	<input checked="" type="checkbox"/>	<input checked="" type="checkbox"/>	<input checked="" type="checkbox"/>	<input checked="" type="checkbox"/>
	507612	Rehm	7-pins Amphenol	<input checked="" type="checkbox"/>	<input checked="" type="checkbox"/>	<input checked="" type="checkbox"/>	<input checked="" type="checkbox"/>	<input checked="" type="checkbox"/>	<input checked="" type="checkbox"/>
9	507613	Rehm	7-pins Amphenol	<input checked="" type="checkbox"/>	<input checked="" type="checkbox"/>	<input checked="" type="checkbox"/>	<input checked="" type="checkbox"/>	<input checked="" type="checkbox"/>	<input checked="" type="checkbox"/>
	507615	Rehm	7-pins Amphenol	<input checked="" type="checkbox"/>	<input checked="" type="checkbox"/>	<input checked="" type="checkbox"/>	<input checked="" type="checkbox"/>	<input checked="" type="checkbox"/>	<input checked="" type="checkbox"/>



8TE TIG EXTRACTOR

TIG EXTRACTOR



SWITCH MODULE OPTIONS

ITEM	PART NO.	DESCRIPTION	PACK QTY
1	8X9518	8TE Switch module 1-button complete	1
2	8X9528	8TE Switch module 2-button complete	1
3	8X9538	8TE Switch module 3-button complete	1
4	8X9558	8TE Switch module 4-button rocker complete	1



All international wear parts are stock products and fully interchangeable.

TIG CONSUMABLES

END FITTINGS

We supply almost every common end fitting for TIG power cables.



CERAMIC CUPS

Complete range of ceramics available.



EXTRACTION



TRANSLAS



WWW.TRA



TRANSLAS
DUTCH WELDING TECHNOLOGY



CLEARO2 



HI-VAC UNITS

EXTRACTION

NO FUMES, ONLY CLEAN AIR





HI-VAC UNITS INTEGRATED FUME EXTRACTION



**CLEARO2
UNITS**



ENGINEERED FOR THE TRANSLAS 8XE MIG, 8XR COBOT & 8TE TIG, EXTRACTOR GUNS **Powerful, Flexible, & Mobile**

The ClearO2 portable extraction units offered by Translas were specially engineered to work with the 8XE MIG, 8XR Cobot, & 8TE TIG Extractors to deliver the best results - up to 98% extraction of welding fumes directly at the source.

The ClearO2 portable extraction units and solutions are ready to use systems, designed for maximum convenience for the welder during work.



CLEAN AIR



AUTOMATIC FILTER CLEANING

The ClearO2 W-series have an automatic cleaning function by reverse compressed air pulse. The moment the under pressure in the filter is too high, the units start to clean the filters automatically. A manual cleaning function can be done by pressing a single button. With a large filter area, the ClearO2 Hi-vac units are the most efficient units of their size.



POWERFUL FILTRATION

With the combination of a 8XE MIG, 8XR Cobot, 8TE TIG Extractor and a ClearO2 unit, the captured fumes are filtered with an efficiency > IFA 99.8%. The powerful solution is suitable for high production welding environments.



LARGE FILTER AREA

This is one of the most efficient units of it's size with a filter area of 54²sq Ft (5 Sq M)



HI-VAC UNITS INTEGRATED FUME EXTRACTION



**CLEAR2
UNITS**



EFFICIENT MOTOR SYSTEM

The electric motor of the units is designed to work continuously. Due to the automatic cleaning function and the simplified motor system, the units' maintenance is minimal, making them long-lasting and time saving. The automatic start/stop function was engineered to preserve energy and synchronize the units with the Translas Extractor guns. The moment the gun is out of the gun holder, the machine automatically starts working.

There are two start/stop options: the clamp, which works on induction, and the gun holder. For both options, after stopping welding or putting the gun back into the holder, the machine stops working after about 20 seconds.

LIGHT & MOBILE

**IFA
99.8%**

**ONLY GENERATES
65dB**

- ✓ **DESIGNED FOR THE 8XE, 8XR, & 8TE EXTRACTORS**
- ✓ **MOBILE, WITH WHEELS OR CRANE HOOKS**
- ✓ **UNITS FOR 1 - 2 WELDERS**
- ✓ **SUITABLE FOR HIGH-PRODUCTION ENVIRONMENTS**
- ✓ **QUIET < 65dB & EFFICIENT**



AUTO START/STOP OPTIONS

These options are designed to work only with the 8XE MIG, 8XR Cobot, & 8TE TIG Extractors by using the clamp auto start/stop.

EXTRACTION





MIG CLEARO2 UNITS INTEGRATED FUME EXTRACTION



**CLEARO2
UNITS**



MIG HI-VAC UNITS

**W
100** CLEARO2
UNIT



MIG HI-VAC UNITS

**W
200** CLEARO2
UNIT

EXTRACTION



MIG CLEARO2 W100 INTEGRATED FUME EXTRACTION

FOR ONE WELDER



**CLEARO2
UNITS**

CLEAN AIR



Dimensions	(L x B x H) 29" x 16" x 22"/26" (without / with wheels)
Implementation	4 wheels, 2 rotating & with locking mechanism
Power Supply	220-240V (W100) 575V-600V (W110) 380-480V (W150)
Motor power	1.5 KW/2 HP (16 Amps)
Suction Flow	Max. 106 CFM (free blowing)
Suction Flow Effective	Max. 38 CFM (Translas Extractors)
Working Pressure	Max. 36,000 Pa (el. controlled) static pressure
Filter Surface	54 sqft active filter surface, filter efficiency: IFA > 99.8%
Working Temperature	0 to +50°C
Max. DC	DC: 100%
Inlet	2"
Weight	99 lbs
Noise Level	Max. dB(A) <65Db(A) (at 100% suction flow)
Filter Method	Disposable HEPA Filter
Certifications	CE, W3, and CSA

PART NO.	DESCRIPTION	PACK QTY
CLEARO2 W100		
3746100100000	ClearO2 Mobile fume unit W100 220-240V 50-60Hz 1.5 kW CSA ready	1
3746110100000	ClearO2 Mobile fume unit W110 575-600V 50-60Hz 1.5 kW CSA ready	1
3746150100000	ClearO2 Mobile fume unit W150 380-480V 50-60Hz 1.5 kW CSA ready	1

Note: Compressed Air - The ClearO2 Units need to be connected at all times to Clean, Dry Regulated (80 PSI) Compressed Air for the self cleaning using a standard airline. There is a 21 cfm draw of air for each pulse.



MIG CLEARO2 W200 INTEGRATED FUME EXTRACTION

FOR TWO WELDERS



**CLEARO2
UNITS**



Dimensions	Dimensions: (L x W x H) 32" x 21" x 27"/31" (without/with wheels)
Implementation	4 wheels, 2 rotating & with locking mechanism
Power Supply	380-480V (W200) 575V-600V (W210)
Motor power	Maximum 4 HP (16 Amps)
Suction Flow	Max. 147 CFM (free blowing)
Suction Flow Effective	Max. 38 CFM (Translas Extractors)
Working Pressure	54 sqft active filter surface, filter efficiency: IFA > 99.8%
Filter Surface	5m ² Active filter surface, filter efficiency: IFA > 99.8%
Working Temperature	0 to +50°C
Max. DC	100% (VFD)
Inlet	2 x 2"
Weight	128 lbs
Noise Level	Max. dB(A) <65dB(A) (at 100% suction flow)
Filter Method	Disposable filter
Certifications	CE, W3, and CSA

EXTRACTION

PART NO.	DESCRIPTION	PACK QTY
CLEARO2 W200		
3746200100000	ClearO2 Mobile fume unit W200 380-480V 50-60Hz 3 kW CSA ready	1
3746210100000	ClearO2 Mobile fume unit W210 575-600V 50-60Hz 3 kW CSA ready	1
3746220100000	ClearO2 Mobile fume unit W220 575-600V 50-60Hz 4 kW CSA ready	1
3746230100000	ClearO2 Mobile fume unit W230 380-480V 50-60Hz 4 kW CSA ready	1

Note: Compressed Air - The ClearO2 Units need to be connected at all times to Clean, Dry Regulated (80 PSI) Compressed Air for the self cleaning using a standard airline. There is a 21 cfm draw of air for each pulse.





TIG CLEARO2 UNITS INTEGRATED FUME EXTRACTION



**CLEARO2
UNITS**



TIG HI-VAC UNITS

T
100 CLEARO2
UNIT



TIG HI-VAC UNITS

T
200 CLEARO2
UNIT

EXTRACTION



TIG CLEARO2 T100

INTEGRATED FUME EXTRACTION

FOR ONE WELDER



**CLEARO2
UNITS**

CLEAN AIR



Dimensions	(L x W x H) 20" x 12" x 15"
Power Supply	230V/50Hz
Motor Power	1.2 KW
Suction Flow	Max. 125m3/h
Suction Flow Effective	Max. 38 CFM (Translas Extractors)
Working Pressure	Max. 30,000Pa
Filter Surface	26 sqft active filter surface
Filter Efficiency	IFA > 99.8%
Inlet	2" (Optional 1.7")
Weight	30 kg
Noise Level	Max. dBA (A) < 65dBA (at 100% Suctionflow)
Filter Method	Disposable filter
Certifications	CSA, CE

W3 is under construction.

Option: Start/Stop cable

PART NO.	DESCRIPTION	PACK QTY
ClearO2 T100		
3756100130000	ClearO2 T100 230V 50Hz 1.2kW CSA	1



TIG CLEARO2 T200 INTEGRATED FUME EXTRACTION

FOR TWO WELDERS



**CLEARO2
UNITS**



Dimensions	(L x B x H) 29" x 16" x 22"/26" (without / with wheels)
Implementation	4 wheels, 2 rotating & with locking mechanism
Power Supply	220-240V (T200)
Motor power	1.5 KW/2 HP (16 Amps)
Suction Flow	Max. 106 CFM (free blowing)
Suction Flow Effective	Max. 38 CFM (Translas Extractors)
Working Pressure	Max. 36,000 Pa (el. controlled) static pressure
Filter Surface	54 sqft active filter surface, filter efficiency: IFA > 99.8%
Working Temperature	0 to +50°C
Max. DC	DC: 100%
Inlet	2"
Weight	99 lbs
Noise Level	Max. dB(A) <65Db(A) (at 100% suction flow)
Filter Method	Disposable filter
Certifications	CE, W3, and CSA

EXTRACTION

PART NO.	DESCRIPTION	PACK QTY
CLEARO2 T200		
3756200100000	ClearO2 T200 220-240V 50-60Hz 1.5kW CSA	1

Note: Compressed Air - The ClearO2 Units need to be connected at all times to Clean, Dry Regulated (80 PSI) Compressed Air for the self cleaning using a standard airline. There is a 21 cfm draw of air for each pulse.



SPARE PARTS FOR HI-VAC UNITS INTEGRATED FUME EXTRACTION



**CLEARO2
UNITS**

CLEAN AIR



PART NUMBER	DESCRIPTION	PACK QTY
374012	Gun holder ø40mm for automatic start/stop 16ft (5mtr) ClearO2	1
374013	Gun holder ø40mm for automatic start/stop 33ft (10mtr) ClearO2	1
374014	Gun holder ø50mm for automatic start/stop 16ft (5mtr) ClearO2	1
374015	Gun holder ø50mm for automatic start/stop 33ft (10mtr) ClearO2	1

PART NUMBER	DESCRIPTION	PACK QTY
374010	Sensing cable auto start / stop 13ft (4mtr) W-serie	1

PART NUMBER	DESCRIPTION	PACK QTY
3740103	Extension cable auto start / stop incl. 5-p plug W-serie 10ft (3mtr)	1
3740105	Extension cable auto start / stop incl. 5-p plug W-serie 16ft (5mtr)	1
3740110	Extension cable auto start / stop incl. 5-p plug W-serie 33ft (10mtr)	1

PART NUMBER	DESCRIPTION	PACK QTY
37422505	ClearO2 suction hose green ø2" 16ft (5mtr)	1

PART NUMBER	DESCRIPTION	PACK QTY
374099	Ball valve to reduce the suction flow	1

PART NUMBER	DESCRIPTION	PACK QTY
374106	Pressure reducing value 5 - 15 bar 1/4"-NP7.2 (80 PSI)	1



SPARE PARTS FOR HI-VAC UNITS

INTEGRATED FUME EXTRACTION



**CLEARO2
UNITS**



PART NUMBER	DESCRIPTION	PACK QTY
374020	Filter - 64 Sq Ft (5m2)	1



PART NUMBER	DESCRIPTION	PACK QTY
374025	Filtermat W-series ClearO2 (set/5pc)	1



PART NUMBER	DESCRIPTION	PACK QTY
398110	Coupler for suction hose ø2" side 8XE	1



PART NUMBER	DESCRIPTION	PACK QTY
374130	Coupler to extend the suction hose ø2"	1



PART NUMBER	DESCRIPTION	PACK QTY
374017	Extraction hood small with magnet base for ClearO2	1

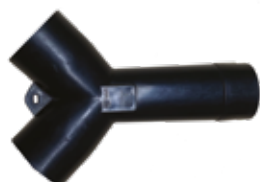

PART NUMBER	DESCRIPTION	PACK QTY
374149	Y-Branch Adapter for T200	1

EXTRACTION



**CLEAR02
UNITS**

HIGH PERFORMANCE CENTRAL VACUUM SYSTEMS

THE ULTIMATE EXPERIENCE IN WELD FUME EXTRACTION

Translas has a complete range of central high vacuum fume extraction systems ranging from 5HP to 75HP units which will handle 5 to 40+ technicians using welding guns at the same time.

KEY BENEFITS:

- Captures dangerous welding fumes before they enter the welder's breathing zone.
- Ideal for MIG, TIG, arc, and robotic welding.
- No lost production time moving large fume extraction arms every time the welder changes position.
- Source capture welding gun at 100 CFM or welding attachments only require 80 CFM, eliminating the need for costly make-up air systems required with high volume systems.
- Several filter options are available, including combination cyclone separators and polyester cartridge filters with automatic pulse jet cleaning.

EXTRACTION



CLEARO2 CW III INTEGRATED FUME EXTRACTION

5 TO 40+ WELDERS



CLEARO2
UNITS

CLEARO2 CW III SUPERIOR FILTRATION

All of our systems use a separator designed to remove debris and particles from the airstream before they reach the exhaust, which is vital in protecting the pump from damage. It also prevents contaminants from being released back into the atmosphere. For removing welding fumes, we use a combination of cyclonic filtration and secondary polyester cartridge filters with automatic compressed air pulse jet cleaning, permitting continuous cleaning while the system is up and running. This is far superior to the automatic shakers often found on bag house separators which can only clean the filters when the system is shut down. This also applies to manual shakers found on many bag house separators, which require a technician to physically shake or operate a handle in order to clean the filters. Due to the production of hexavalent chromium fumes, the OSHA decreed the welding of stainless steel to be a health hazard to operators. It is now a requirement for fumes to be filtered, not only with standard nanofiber filters, but with HEPA filters as well.

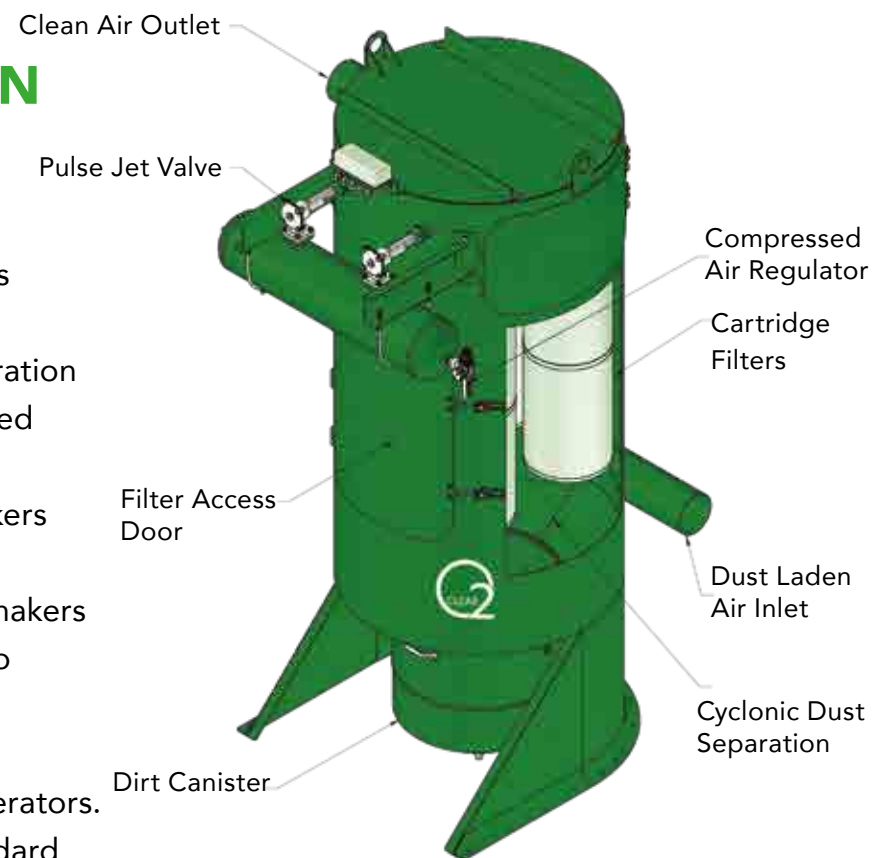

EXTRACTION



CLEARO2 CW III INTEGRATED FUME EXTRACTION

5 TO 40+ WELDERS



CLEARO2
UNITS

CLEARO2 CW III CENTRIFUGAL MULTI-STAGE PUMP SYSTEM



- Ideal for production shops with 5 to 40+ users welding at the same time.
- 10 - 150 (two 75HP units) centrifugal multi-stage pump units can be set at various vacuum levels from 5" HG (68" water column) for short pipe runs to 10" HG (135" water column) to offset friction losses on long pipe runs.
- Large aluminum impellers and fabricated housings result in a vacuum pump that is far more efficient than competitive products (which typically have smaller steel impellers and sections held together with tie-rods).
- Comes equipped with cartridge filters, automatic compressed air pulse jet cleaning, and primary cyclonic separation.
- Our industrial grade induction motors have a 20,000+ hours rating.

CLEAN AIR



CLEARO2 CW III INTEGRATED FUME EXTRACTION

5 TO 40+ WELDERS



CLEARO2
UNITS

DROPS AND PIPE FITTINGS

Translas systems are designed for convenient use with vacuum drops (or work stations) and can be placed exactly where you need them for increased productivity. Work stations can also be equipped with microswitches so that the system turns on and off automatically. Metal tubing is superior to PVC or ABS piping as it has long radius bends and does not generate static electricity. All of our systems use graduated 14 to 16 gauge steel tubing secured with heat shrink sleeves or optional compression couplings. The system is also guaranteed to maintain airflow at approximately 100 cubic feet per minute at each vacuum inlet port.



Single Wall-Mounted
or Hanging Drops



Double Wall-Mounted
or Hanging Drops

WORKS WITH WELDING GUNS, GRINDERS, & CLEANING ACCESSORIES



EXTRACTION



GIANT PORTABLE INTEGRATED FUME EXTRACTION

ONE & TWO WELDERS



CLEAR
UNITS



GIANT PORTABLE FUME EXTRACTOR

Translas's portable fume extractor "Giant" is designed to capture and filter dry impurities created during welding, grinding, and the cutting of metals.

- Meets OSHA air quality standards and increases health and safety standards by minimizing hazards that cause respiratory ailments
- Available with two arm options: 1 x 8-inch arm or 2 x 6-inch arms. Self supporting joints and flexible hoses for easy placement with smooth bore tubing for unimpeded air movement.
- 1,200 CFM at hood for powerful performance.
- Excellent three-stage filtration: aluminum mesh pre-filter, second polyester cartridge filters, and final carbon after filter. Manual pulse jet cleaning comes standard and optional HEPA upgrade available.
- Unit reduces facility maintenance costs by eliminating smoke and dust before particles settle on equipment and work surfaces.

CLEAN AIR

Dimensions	(L x W x H) 48" x 37" x 51" (without/with wheels)
Voltage	3 Phase 60Hz*
Power	208-240, 460 & 575 volts
Current Draw	11 amps
Airflow	1,200 cfm
Weight	430 lbs.
Sound Level @ 10'	85 dB(A)
Filter Area	452 ft
Filter Efficiency	99.93% @ 3 microns
HEPA (optional)	99.97% @ 0.3 microns

* 50Hz available on request

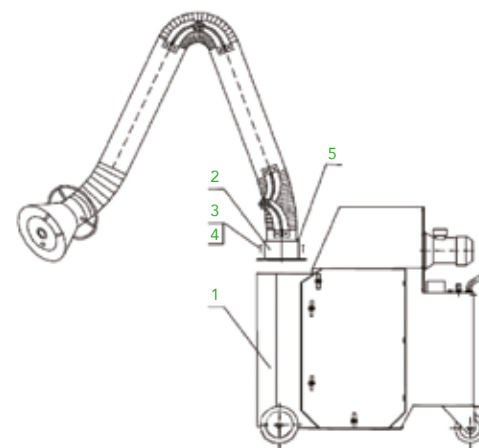

Optional Dual Arm



ROLLOUT PORTABLE INTEGRATED FUME EXTRACTION

ONE WELDER



**CLEAR2
UNITS**



ROLLOUT PORTABLE FUME EXTRACTOR

Translas's Rollout portable fume extractor is designed to capture and filter dry impurities created during welding, grinding, and the cutting of metals.

- Meets OSHA air quality standards and increases health and safety standards by minimizing hazards that cause respiratory ailments.
- Standard arm measures 6" in diameter and fully extends to 10-feet. Other sizes also available on request.
- 700 CFM at hood for powerful performance.
- Excellent three-stage filtration: aluminum mesh pre-filter, second polyester cartridge filters, and final carbon after filter. Manual pulse jet cleaning comes standard and optional HEPA upgrade available.
- Unit reduces facility maintenance costs by eliminating smoke and dust before particles settle on equipment and work surfaces.

Dimensions	(L x W x H) 35" x 30" x 55" (without/with wheels)
Voltage	1 Phase 60Hz*
Power	115 volts
Current Draw	15 amps
Airflow	700 cfm
Weight	320 lbs.
Sound Level @ 8'	69 dB(A)
Filter Area	226 ft
Filter Efficiency	99.93% @ 3 microns
HEPA (optional)	99.97% @ 0.3 microns

* 50Hz available on request

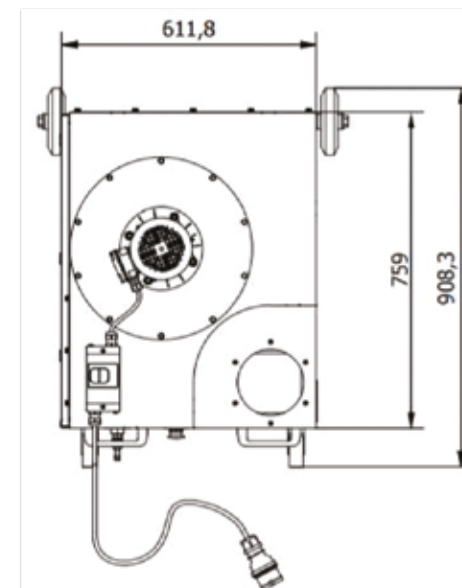
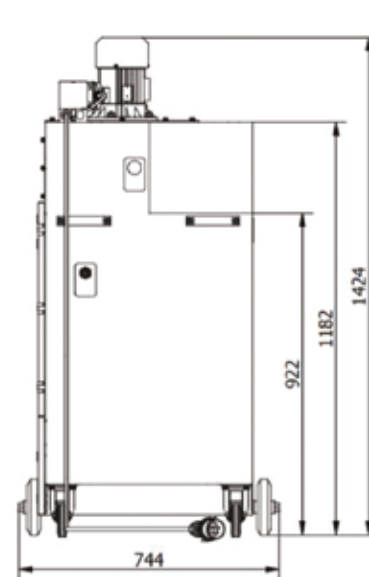

EXTRACTION



CLEARO2 CFA100 FUME ARMS FUME EXTRACTION

ONE & TWO WELDERS



CLEARO2
UNITS



CEILING OR WALL MOUNT CARTRIDGE COLLECTOR

Shop managers are aware that floor space is vital and every square foot is accounted for. **The ClearO2 CFA100** cartridge collectors designed to be installed hanging from the ceiling or from a wall solves the issue of finding space for new or retrofitted welding or metal transforming work stations. **The ClearO2 CFA100** dust collectors with automatic pulse cleaning for the highly efficient cartridges ensures worry free maintenance.

The standard NEMA 4 control panel with starter and overload comes complete with single-point wiring, transformer, ON/OFF switches and pilot lights. The unit can be connected to fume arms by means of companion flanges for direct mounting underneath the cartridges or remote using standard spiral or clamp-on ductwork. Washable aluminum spark trap filters, removable dust drawers and acoustical fan housing are also included with the unit.

CLEAN AIR

The ClearO2 CFA100 cartridge collectors are equipped with 6" or 8" diameter source capture fume arms. Fume arms can be direct mounted to the unit with matching support flanges or remote to independent workstations and connected to the unit by means of standard spiral or clamp-on ductwork. The 3 HP fan is powerful enough to be used with (2) fume arms. When more air is required, the 5 HP fan will be adequate.



Motor (TEFC)	3 or 5 HP
Air Volume	2,000 to 2,500 CFM
Voltages	230/460/575
Cartridges	2 or 4
Efficiency	MERV 13 or 15
Surface	260 to 1,248 s.f
Housing	12 and 14 gauge (painted)
Compressed Air Requirement	60 to 90 PSI
Air Outlet	Adjustable louvers
Air Inlets 2	2 (6" or 8")
Installation	Wall or ceiling
Cleaning	Automatic air pulse

NOTES

Demo Request

Scan the QR code with your smart phone



▶ BY WELDERS. FOR WELDERS

TRANSLAS
DUTCH WELDING TECHNOLOGY



NORTH AMERICA



+1-888-383-9080



5, 1099 Commerce Way
Woodstock, ON
N4V 0A2 Canada



info-NA@translas.com

www.translas.com



EUROPE

UNITED KINGDOM

NORTH AMERICA